

Prepared by the Army Map Service (ASAT) Corps of Engineers, U.S. Army, Washington, D.C. Compiled in 1955 by photogrammetric methods and from United States Quadrangles, 1:24,000 and 1:125,000, U.S.G.S., 1899-1953. Planimetric detail revised by photogrammetric methods. Horizontal and vertical control by USC&GS, USGS and CE. Photography field annotated 1955.
 100,000 foot grid based on Wyoming coordinate system, east zone, and South Dakota coordinate system, north zone.
 10,000 meter Universal Transverse Mercator grid ticks, zone 13, shown in blue.

LEGEND

ROAD DATA 1955
 Figures in red denote approximate distances in miles between stars

POPULATED PLACES
 Over 500,000
 100,000 to 500,000
 25,000 to 100,000
 5,000 to 25,000
 1,000 to 5,000
 Less than 1,000

RAILROADS
 Single track
 Double or Multiple track
 Standard gauge
 Narrow gauge

BOUNDARIES
 International
 State
 County
 Park or reservation

Other Features:
 Landmarks: School; Church; Other
 Horizontal control point
 Spot elevation in feet
 Marsh or swamp
 Intermittent or dry stream
 Power line

ROADS
 Hard surface, heavy duty
 More than two lanes wide
 Two lanes wide; Federal route marker
 Hard surface, medium duty
 More than two lanes wide
 Two lanes wide; State route marker
 Improved light duty
 Unimproved dirt
 Trail

Airports:
 Landplane airport
 Landing area
 Seaplane airport
 Dry lake

Vegetation:
 Woods/brushwood

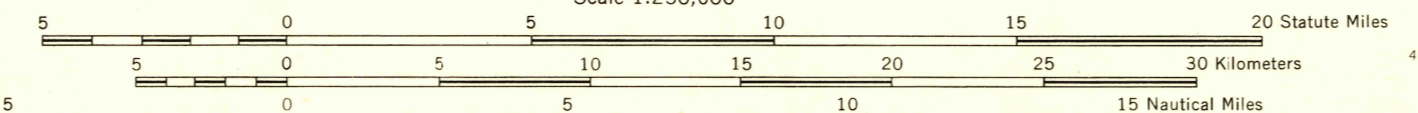

CONTOUR INTERVAL 200 FEET
 TRANSVERSE MERCATOR PROJECTION

1955 MAGNETIC DECLINATION FOR THIS SHEET VARIES FROM 15°00' EASTERLY FOR THE CENTER OF THE WEST EDGE TO 14°00' EASTERLY FOR THE CENTER OF THE EAST EDGE. MEAN ANNUAL CHANGE IS 0°03' WESTERLY.

FOR SALE BY U. S. GEOLOGICAL SURVEY, DENVER 2, COLORADO OR WASHINGTON 25, D. C.

LOCATION DIAGRAM FOR NK 13-2

110°	111°	112°	113°	114°	115°	116°	117°	118°	119°	120°
43°	44°	45°	46°	47°	48°	49°	50°	51°	52°	53°
NEBRASKA	NEBRASKA	NEBRASKA	NEBRASKA	NEBRASKA	NEBRASKA	NEBRASKA	NEBRASKA	NEBRASKA	NEBRASKA	NEBRASKA
WYOMING	WYOMING	WYOMING	WYOMING	WYOMING	WYOMING	WYOMING	WYOMING	WYOMING	WYOMING	WYOMING
NEBRASKA	NEBRASKA	NEBRASKA	NEBRASKA	NEBRASKA	NEBRASKA	NEBRASKA	NEBRASKA	NEBRASKA	NEBRASKA	NEBRASKA
NEBRASKA	NEBRASKA	NEBRASKA	NEBRASKA	NEBRASKA	NEBRASKA	NEBRASKA	NEBRASKA	NEBRASKA	NEBRASKA	NEBRASKA
NEBRASKA	NEBRASKA	NEBRASKA	NEBRASKA	NEBRASKA	NEBRASKA	NEBRASKA	NEBRASKA	NEBRASKA	NEBRASKA	NEBRASKA

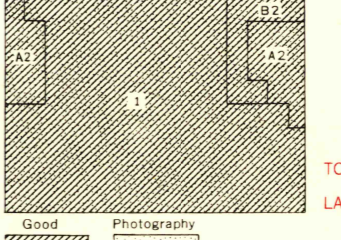

A. Large scale topographic maps, photogrammetric, 1951-53.
 B. Medium scale topographic maps, controlled ground survey, 1899.
 1. Stereo-compiled from 1954 aerial photography.
 2. Planimetry revised from 1954 aerial photography.

INTERIOR-GEOLOGICAL SURVEY, WASHINGTON, D. C. - 1958-NB
 M R-2767

SECTIONIZED TOWNSHIP

6	5	4	3	2	1
7	8	9	10	11	12
13	14	15	16	17	18
19	20	21	22	23	24
25	26	27	28	29	30
31	32	33	34	35	36

NEWCASTLE, WYOMING; SOUTH DAKOTA; NEBRASKA

