

UNITED STATES  
DEPARTMENT OF THE INTERIOR  
GEOLOGICAL SURVEY

WILLOW LAKE QUADRANGLE  
SOUTH DAKOTA—CLARK CO.  
7.5 MINUTE SERIES (TOPOGRAPHIC)

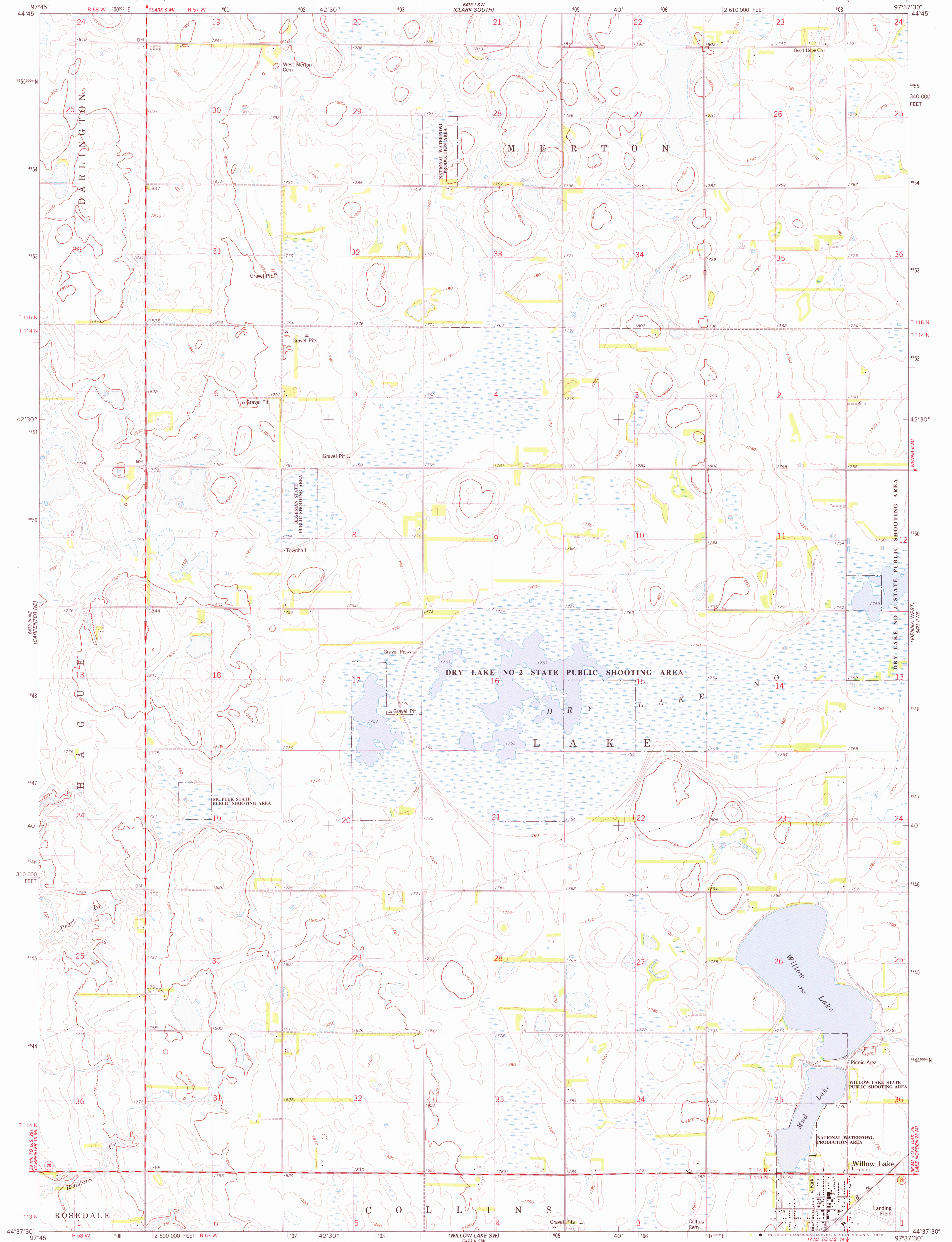

Mapped, edited, and published by the Geological Survey  
Control by USGS and NOS/NOAA  
Topography by photogrammetric methods from aerial photographs taken 1973. Field checked 1973  
Projection and 10,000-foot grid ticks: South Dakota coordinate system, north zone (Lambert conformal conic)  
1000-meter Universal Transverse Mercator grid ticks, zone 14, shown in blue. 1927 North American datum  
Fine red dashed lines indicate selected fence and field lines where generally visible on aerial photographs. This information is unchecked

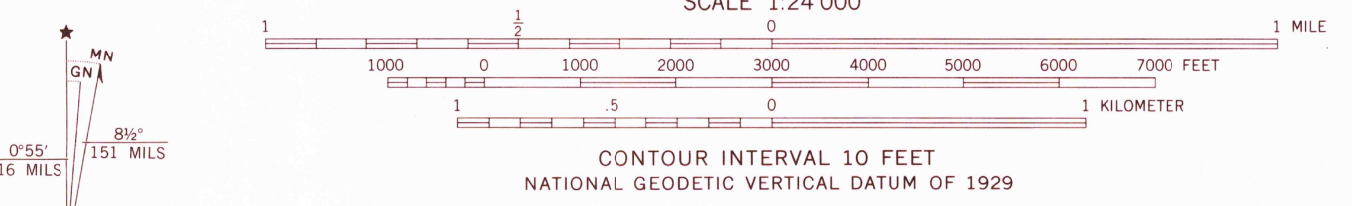

**ROAD CLASSIFICATION**

- Primary highway, hard surface
- Secondary highway, hard surface
- Unimproved road, hard surface
- Light-duty road, hard or improved surface
- Interstate Route
- U. S. Route
- State Route

**QUADRANGLE LOCATION**

THIS MAP COMPLIES WITH NATIONAL MAP ACCURACY STANDARDS  
FOR SALE BY U. S. GEOLOGICAL SURVEY, DENVER, COLORADO 80225, OR RESTON, VIRGINIA 22092  
A FOLDER DESCRIBING TOPOGRAPHIC MAPS AND SYMBOLS IS AVAILABLE ON REQUEST

USGS Historical Topographic Division  
WILLOW LAKE, S. DAK.  
N4437.5-W9737.5/7.5  
1973  
AMS 6473 II NW—SERIES V873

JUN 21 1978  
2800