

5572 III SE
(WASTA NE)

UNITED STATES
DEPARTMENT OF THE INTERIOR
GEOLOGICAL SURVEY

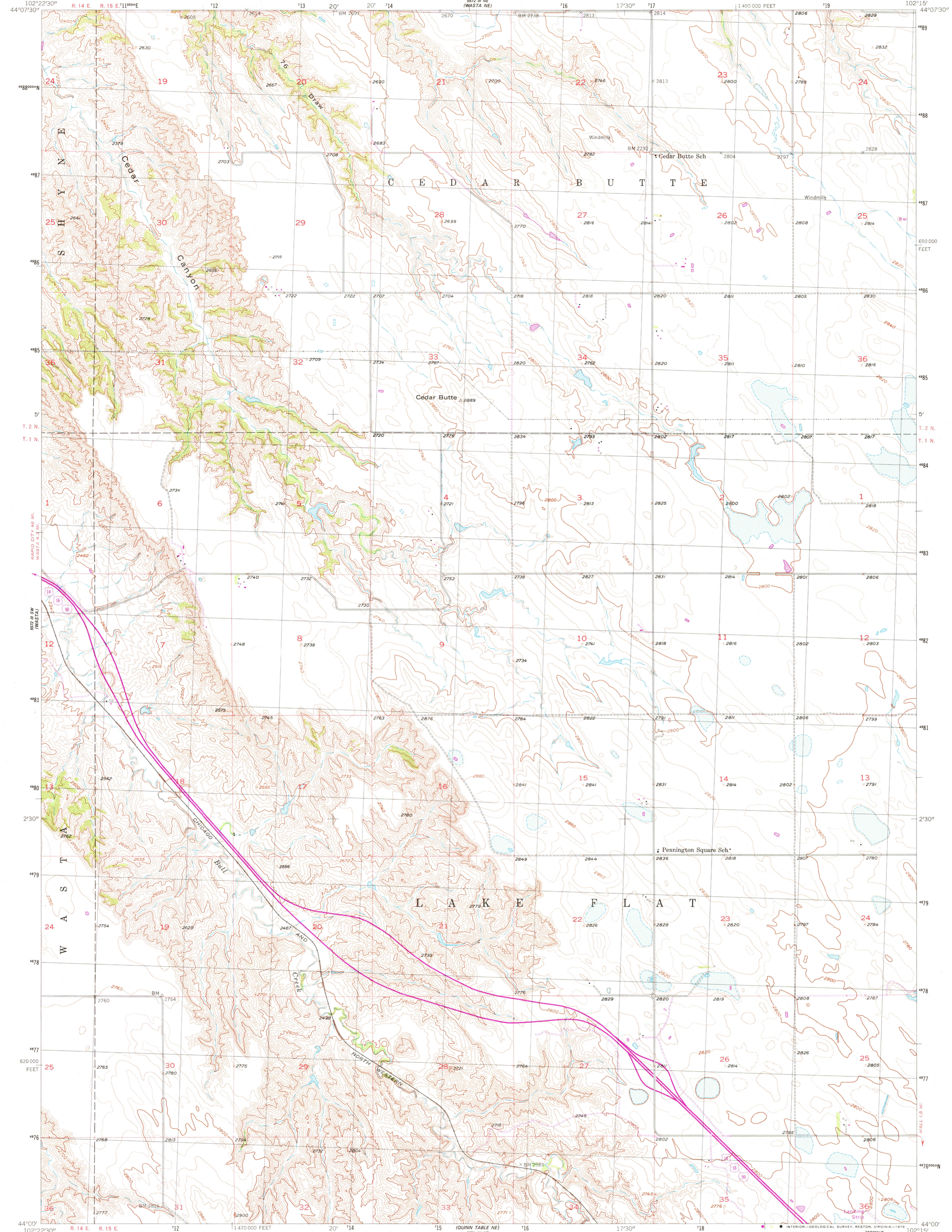

WASTA SE QUADRANGLE
SOUTH DAKOTA—PENNINGTON CO.
7.5 MINUTE SERIES (TOPOGRAPHIC)



Mapped, edited, and published by the Geological Survey as part of the Department of the Interior program for the development of the Missouri River Basin. Control by USGS and USC&GS. Topography from aerial photographs by multiplex methods. Aerial photographs taken 1948. Field check 1954. Polyconic projection. 1927 North American datum. 10,000-foot grid based on South Dakota coordinate system, south zone. 1000-meter Universal Transverse Mercator grid, zone 13. Revisions shown in purple compiled from aerial photographs taken 1976 and other source data. This information not field checked. Map edited 1979.

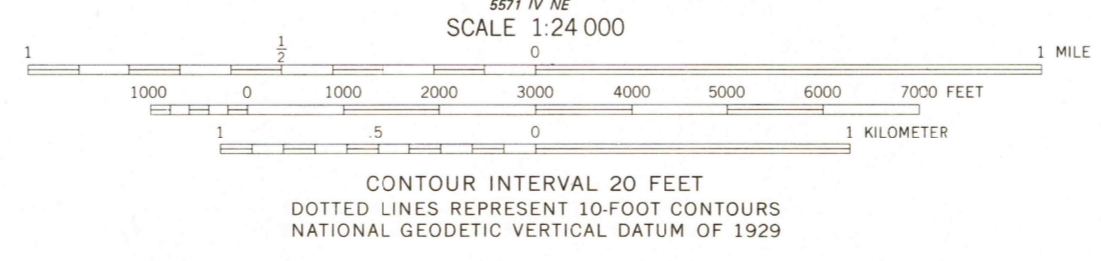
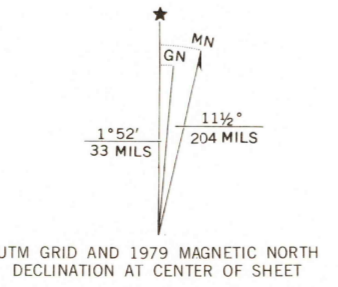

ROAD CLASSIFICATION

Primary highway, all weather, hard surface	Light-duty road, all weather, improved surface
Secondary highway, all weather, hard surface	Unimproved road, fair or dry weather
Interstate Route	U.S. Route
	State Route

MAY 0 1 1979

USGS
Historical File
Topographic Division
WASTA SE, S. DAK.
N4400-W10215/7.5
1954
PHOTOREVISED 1979
AMS 5572 III SE—SERIES V873

THIS MAP COMPLIES WITH NATIONAL MAP ACCURACY STANDARDS
FOR SALE BY U. S. GEOLOGICAL SURVEY, DENVER, COLORADO 80225, OR RESTON, VIRGINIA 22092
A FOLDER DESCRIBING TOPOGRAPHIC MAPS AND SYMBOLS IS AVAILABLE ON REQUEST

1950