

UNITED STATES
DEPARTMENT OF THE INTERIOR
GEOLOGICAL SURVEY

TWO TOP BUTTE SE QUADRANGLE
SOUTH DAKOTA—BUTTE CO.
7.5 MINUTE SERIES (TOPOGRAPHIC)

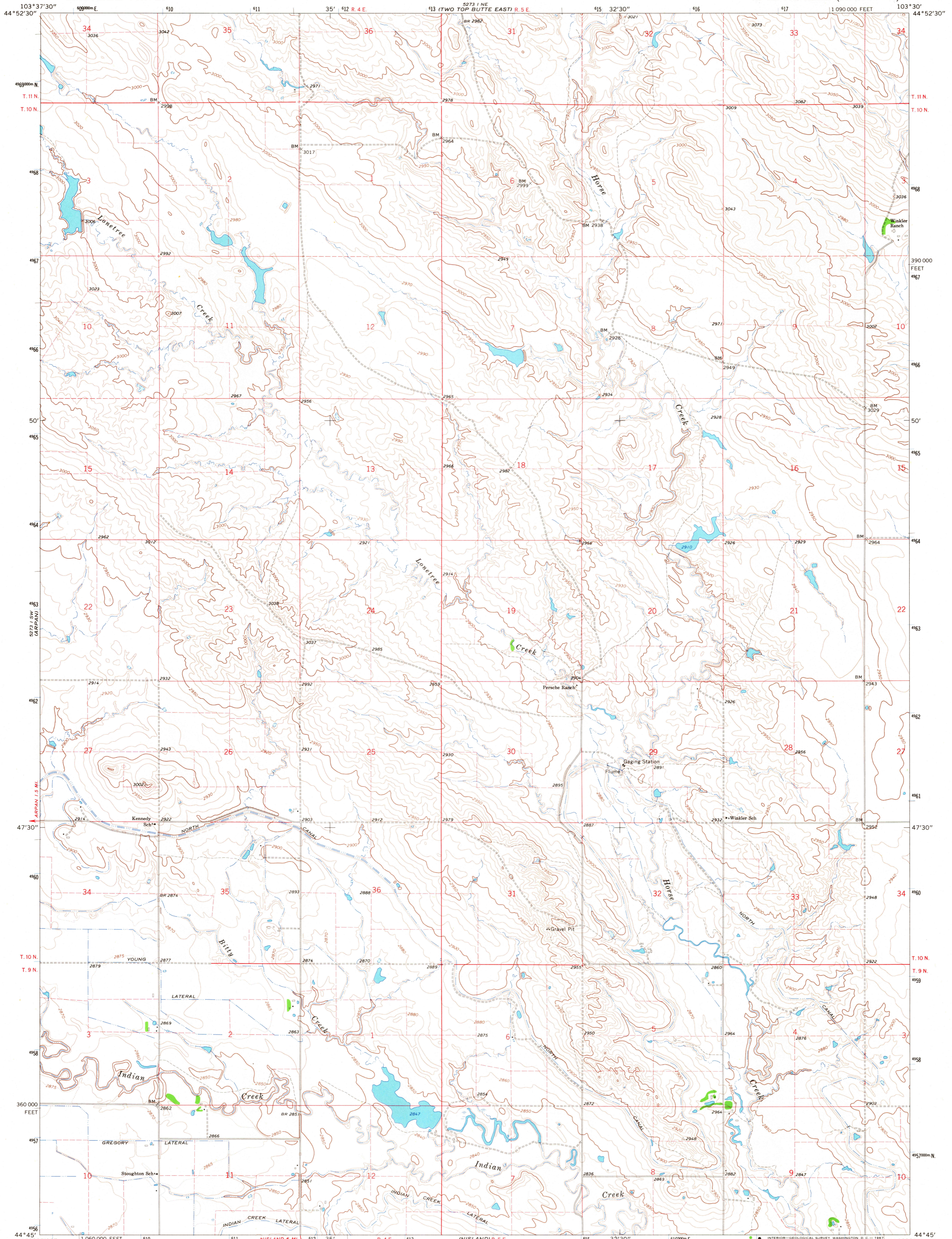

Mapped, edited, and published by the Geological Survey

Control by USGS and USC&GS

Topography by photogrammetric methods from aerial photographs taken 1963. Field checked 1965

Polyconic projection. 1927 North American datum

10,000-foot grid based on South Dakota coordinate system, north zone

1000-meter Universal Transverse Mercator grid ticks, zone 13, shown in blue

Fine red dashed lines indicate selected fence and field lines where generally visible on aerial photographs

This information is unchecked

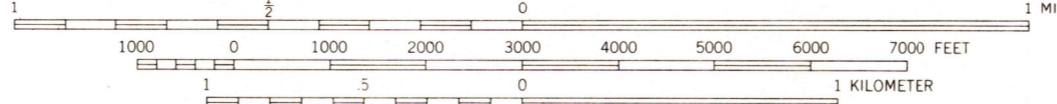
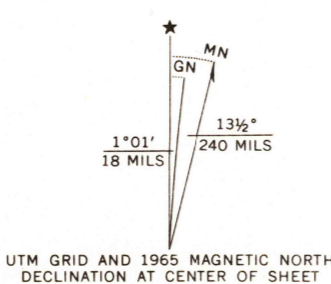

SCALE 1:24 000
CONTOUR INTERVAL 10 FEET
DOTTED LINES REPRESENT 5-FOOT CONTOURS
DATUM IS MEAN SEA LEVEL

USGS
HISTORICAL FILE
TOPOGRAPHIC DIVISION

ROAD CLASSIFICATION
Light duty ————— Unimproved dirt - - - - -

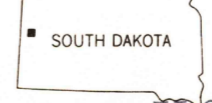

FILE COPY
TOPOGRAPHIC DIVISION

TWO TOP BUTTE SE, S. DAK.
N4445—W10330/7.5

1965

AMS 5273 I SE—SERIES V873

3250

OCT 6 1967