

UNITED STATES  
DEPARTMENT OF THE INTERIOR  
GEOLOGICAL SURVEY

STOVE CREEK QUADRANGLE  
SOUTH DAKOTA—DEWEY CO.  
7.5 MINUTE SERIES (TOPOGRAPHIC)

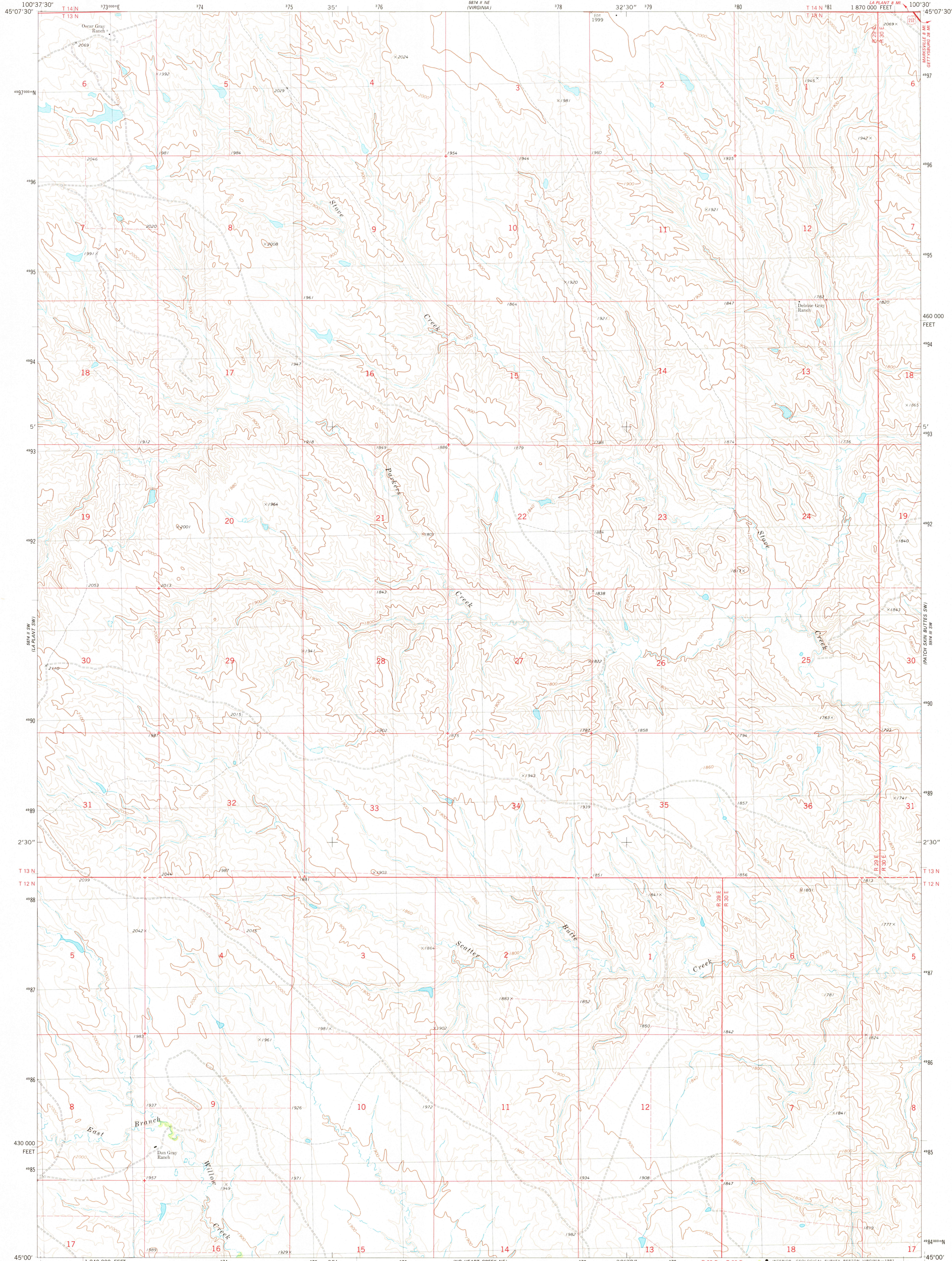

Mapped, edited, and published by the Geological Survey

Control by USGS and NOS/NOAA  
Topography by photogrammetric methods from aerial photographs taken 1974. Field checked 1976. Map edited 1981  
Projection and 10,000-foot grid ticks: South Dakota coordinate system, north zone (Lambert conformal conic)  
1000-meter Universal Transverse Mercator grid, zone 14 1927 North American Datum  
To place on the predicted North American Datum 1983 move the projection lines 6 meters north and 35 meters east as shown by dashed corner ticks  
There may be private inholdings within the boundaries of the National or State reservations shown on this map  
Entire area lies within the Cheyenne River Indian Reservation  
Fine red dashed lines indicate selected fence and field lines where generally visible on aerial photographs. This information is unchecked

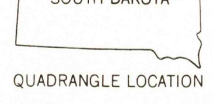
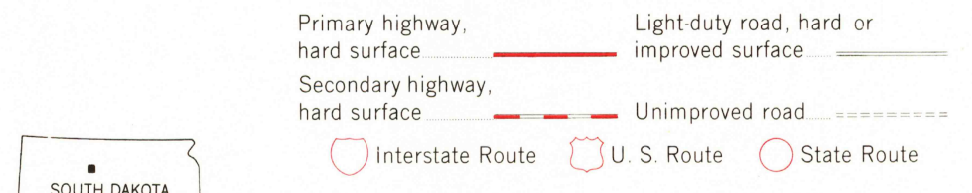
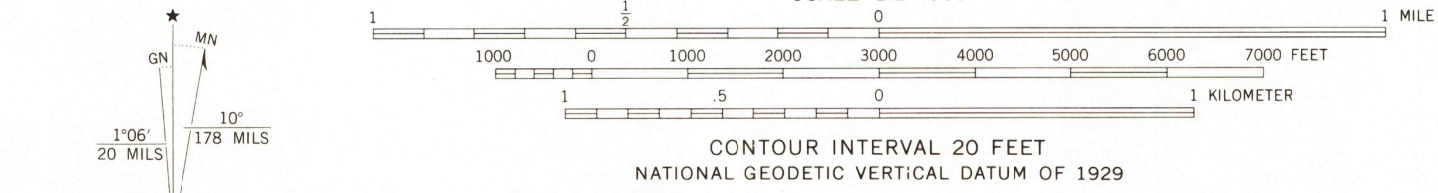

THIS MAP COMPLIES WITH NATIONAL MAP ACCURACY STANDARDS  
FOR SALE BY U. S. GEOLOGICAL SURVEY, DENVER, COLORADO 80225, OR RESTON, VIRGINIA 22092  
A FOLDER DESCRIBING TOPOGRAPHIC MAPS AND SYMBOLS IS AVAILABLE ON REQUEST

STOVE CREEK, S. DAK.  
N4500-W10030/7.5  
1981  
DMA 5874 II SE—SERIES V873

RETURN TO:  
USGS AND HISTORICAL MAP ARCHIVES

186102 L30

260