

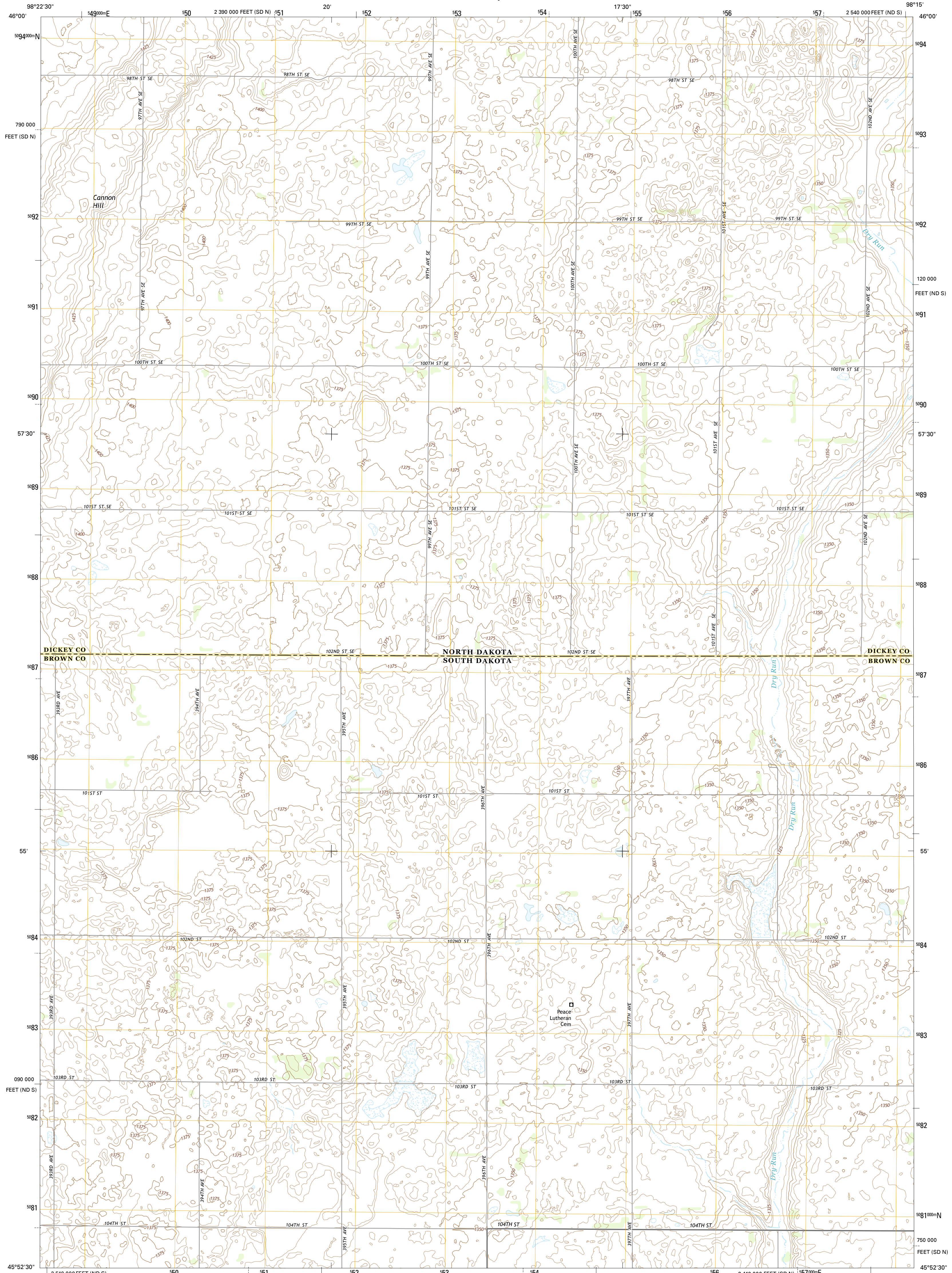

U.S. DEPARTMENT OF THE INTERIOR  
U.S. GEOLOGICAL SURVEY



SAVO NE QUADRANGLE  
SOUTH DAKOTA-NORTH DAKOTA  
7.5-MINUTE SERIES



**Produced by the United States Geological Survey**  
North American Datum of 1983 (NAD83)  
World Geodetic System of 1984 (WGS84). Projection and  
1 000-meter grid: Universal Transverse Mercator, Zone 14T  
10 000-foot ticks: North Dakota Coordinate System of 1983  
(south zone), South Dakota Coordinate System of 1983 (north  
zone)  
This map is not a legal document. Boundaries may be  
generalized for this map scale. Private lands within government  
reservations may not be shown. Obtain permission before  
Imagery.....NAIP, June 2014  
Roads.....HERE, ©2013 2014  
Names.....GNIS, 2015  
Hydrography.....National Hydrography Dataset, 2014  
Contours.....National Elevation Dataset, 2014  
Boundaries.....Multiple sources; see metadata file 1972 - 2015  
Public Land Survey System.....BLM, 2011 - 2015

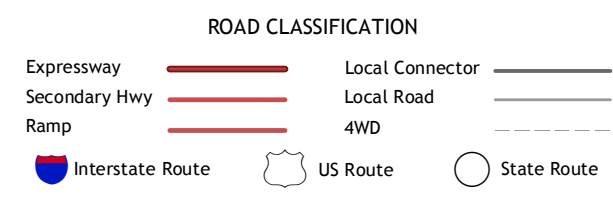
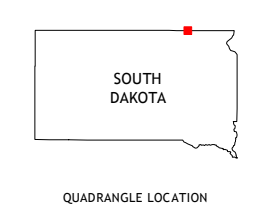
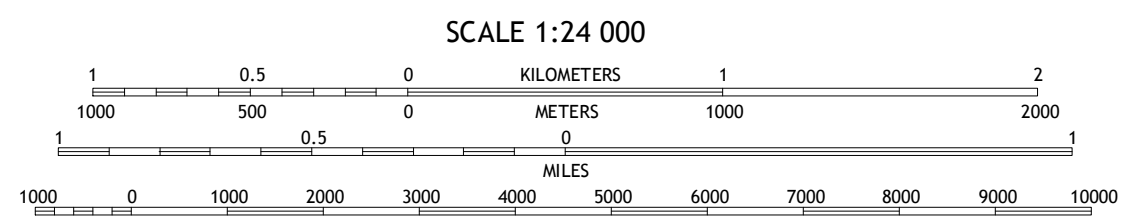
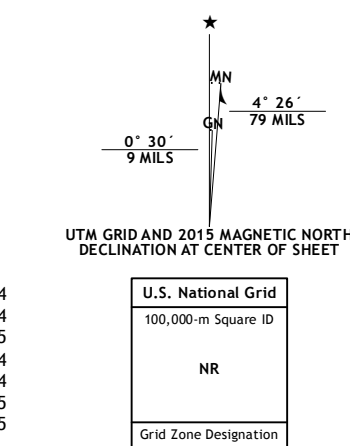

ADJOINING QUADRANGLES

1	2	3
4	5	6
7	8	9

1 Silverleaf  
2 Fullerton SE  
3 Guelph  
4 Savo NW  
5 Hecla  
6 Savo SW  
7 Savo SE  
8 Houghton

SAVO NE, SD-ND  
2015

