

U. S. G. S.
FILE COPY
Inspection and Editing.

UNITED STATES
DEPARTMENT OF THE INTERIOR
GEOLOGICAL SURVEY

SOUTH DAKOTA
RAPID QUADRANGLE

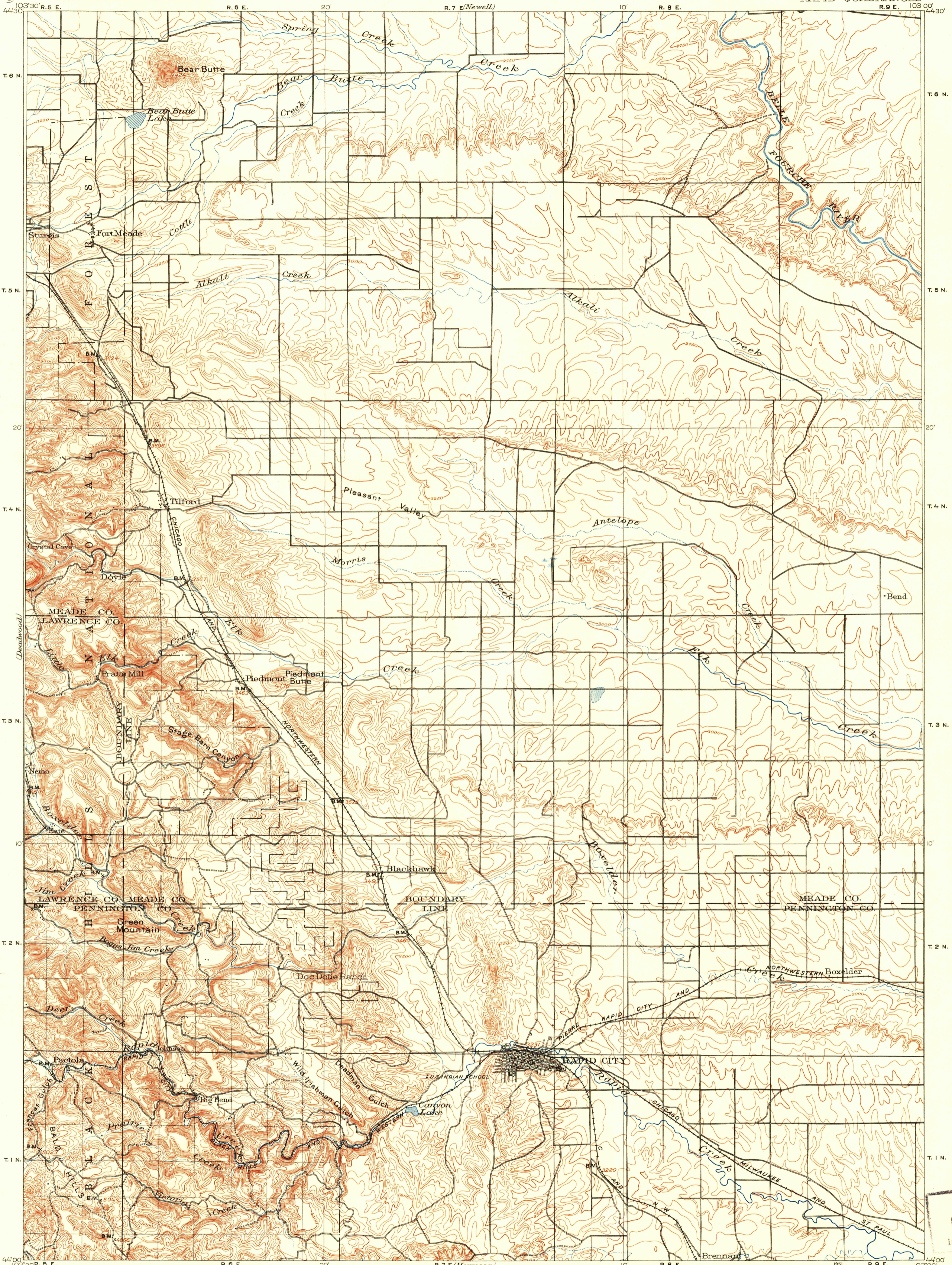

(Beale Fourche)
(Harney Peaks)

A. H. Thompson, Geographer.
W. D. Johnson, Topographer in charge.
Triangulation by E. M. Douglas.
Topography by R. A. Farmer and W. J. Lloyd.
Surveyed in 1891-98.

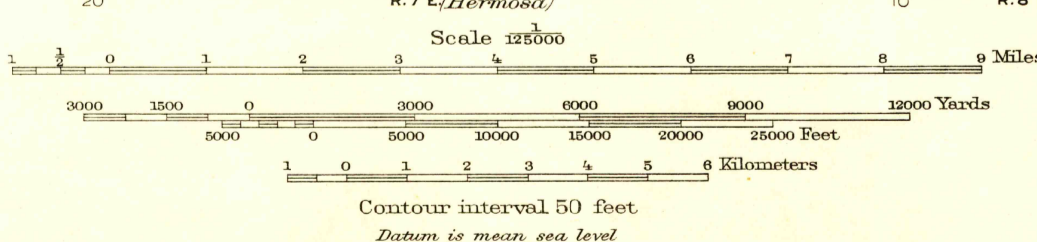
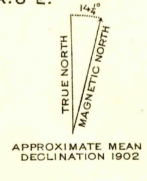

DIAGRAM OF TOWNSHIP

6	5	4	3	2	1
7	8	9	10	11	12
13	14	15	16	17	18
19	20	21	22	23	24
25	26	27	28	29	30
31	32	33	34	35	36

Polyconic projection.

S. DAK.
RAPID
1898
N 4400 - W 10300/30

FOR SALE BY U.S. GEOLOGICAL SURVEY, FEDERAL CENTER, DENVER, COLORADO OR WASHINGTON 25, D.C.
A FOLDER DESCRIBING TOPOGRAPHIC MAPS AND SYMBOLS IS AVAILABLE ON REQUEST

USGS
HISTORICAL FILE
TOPOGRAPHIC DIVISION

Name changed to Rapid City
6-17-54 JEB

NOV 14 1951 2200