

CLARK LAKE

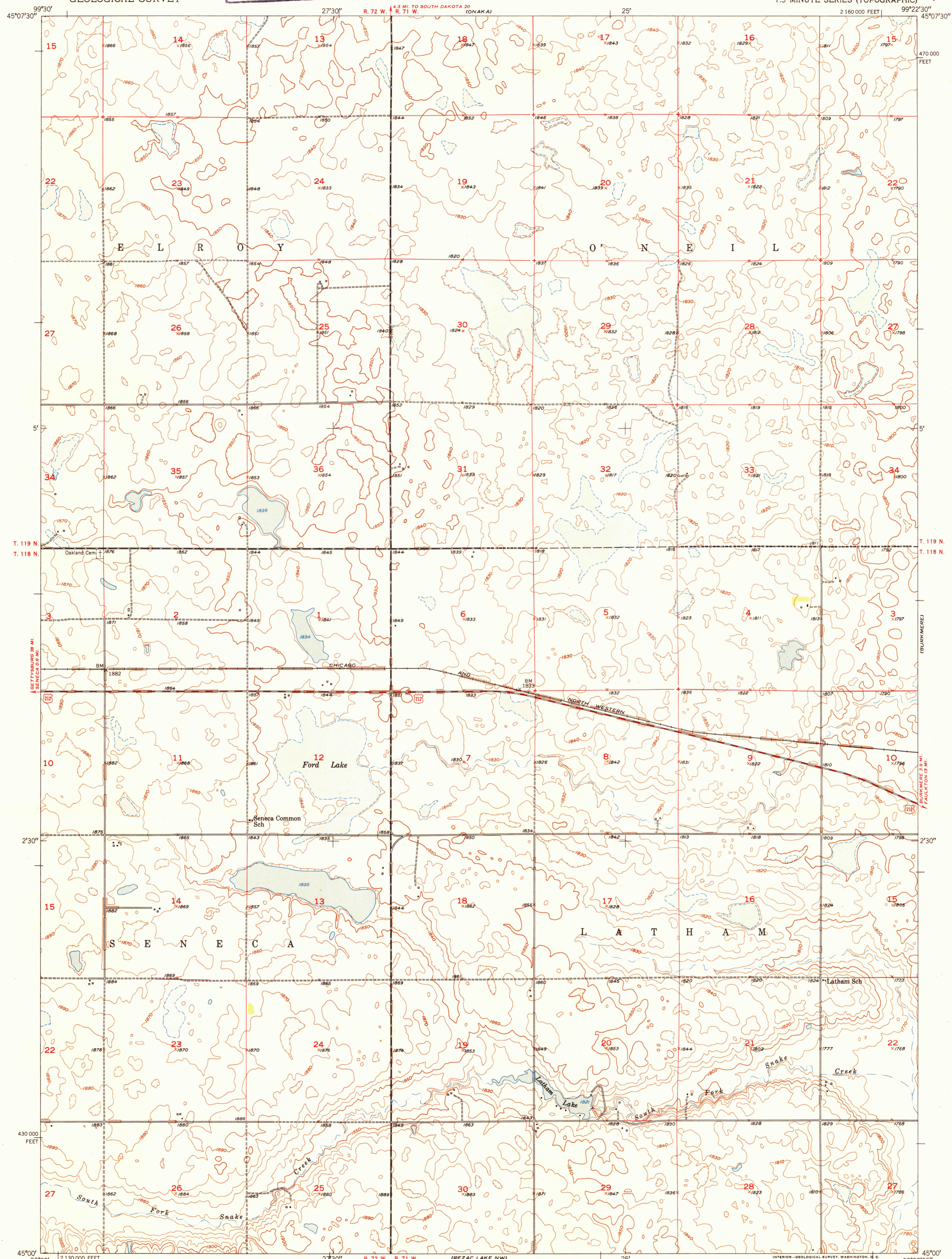

T. 119 N.
T. 118 N.

T. 119 N.
T. 118 N.

10
11
12
13
14
15

10
11
12
13
14
15

27
26
25
24
23
22

27
26
25
24
23
22

Mapped, edited, and published by the Geological Survey as part of the Department of the Interior program for the development of the Missouri River Basin.
Control by USGS and USC&GS
Culture and drainage in part compiled from aerial photographs taken 1948
Topography by plane-table methods 1950
Polyconic projection. 1927 North American datum
10,000-foot grid based on South Dakota coordinate system, north zone
APPROXIMATE MEAN DECLINATION, 1950

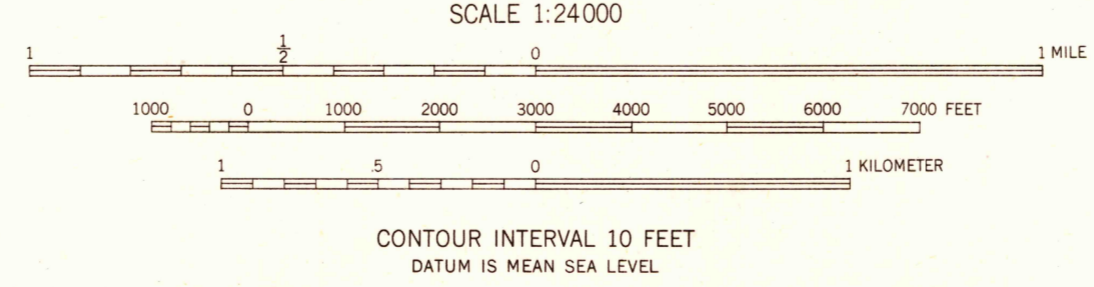
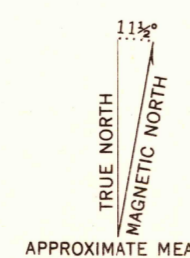

CONTOUR INTERVAL 10 FEET
DATUM IS MEAN SEA LEVEL



ROAD CLASSIFICATION

Heavy-duty	4 LANE 16 LANE	Light-duty
Medium-duty	4 LANE 16 LANE	Unimproved dirt

U. S. Route (circle with number)
State Route (circle with number)