

UNITED STATES
DEPARTMENT OF THE INTERIOR
GEOLOGICAL SURVEY

OLDHAM NW QUADRANGLE
SOUTH DAKOTA
7.5 MINUTE SERIES (TOPOGRAPHIC)

LAKE PRESTON WEST
LAKE PRESTON EAST

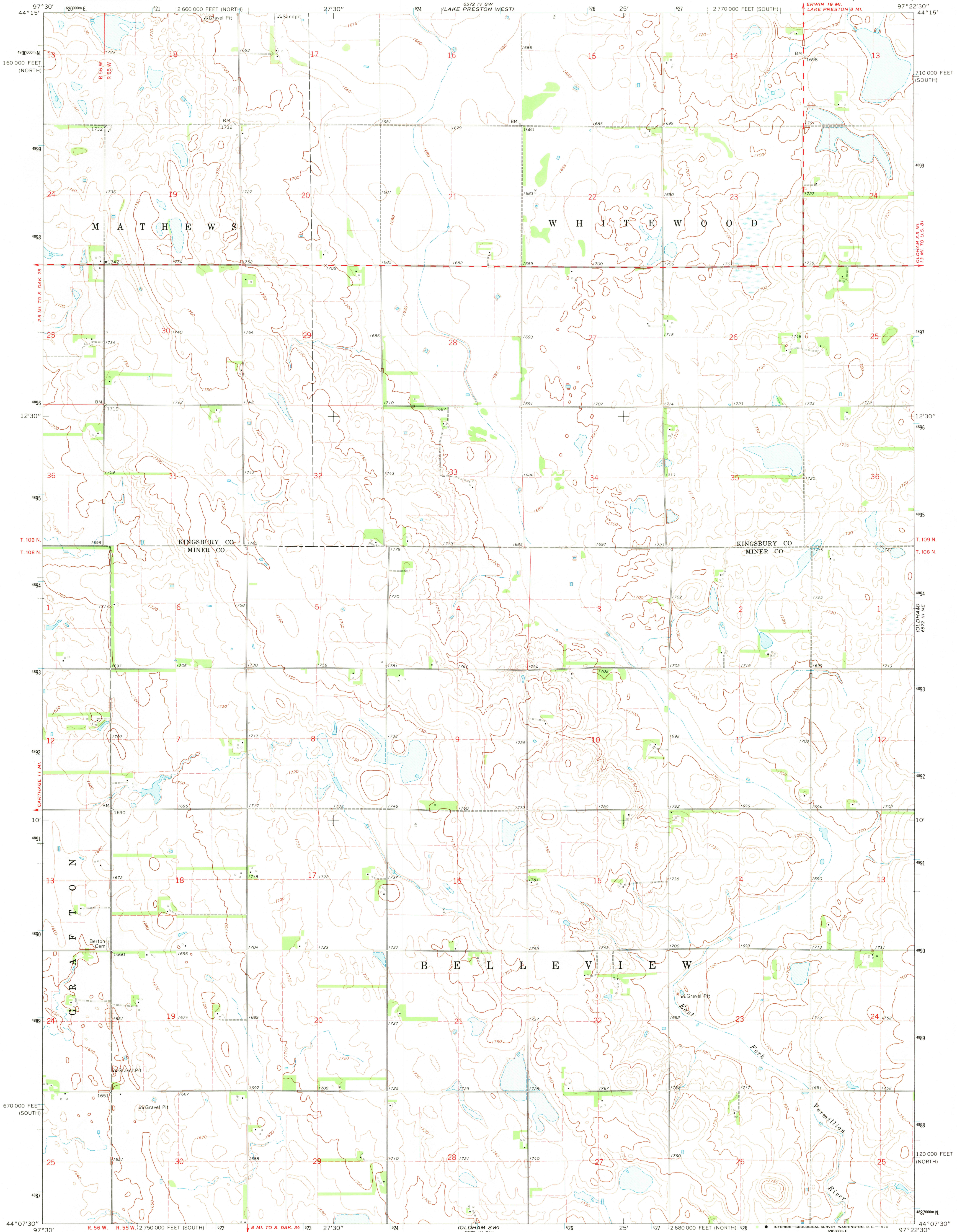

Mapped, edited, and published by the Geological Survey
Control by USGS and USC&GS
Topography by photogrammetric methods from aerial
photographs taken 1965. Field checked 1968
Polyconic projection: 1927 North American datum
10,000-foot grids based on South Dakota coordinate system,
south and north zones
1000-meter Universal Transverse Mercator grid ticks,
zone 14, shown in blue
Fine red dashed lines indicate selected fence and field lines where
generally visible on aerial photographs
This information is unchecked

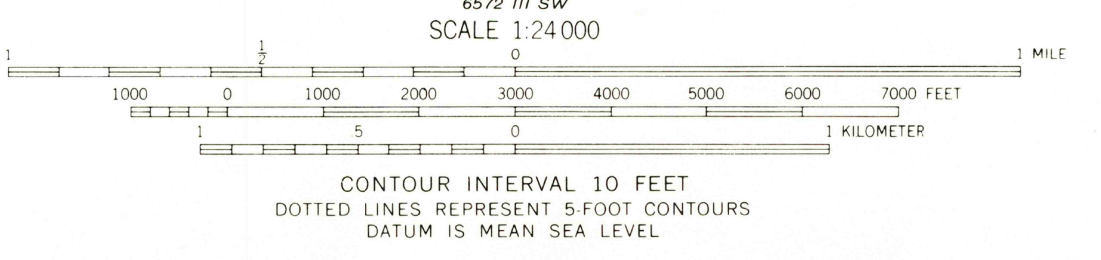
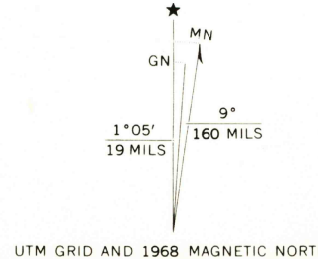

USGS
HISTORICAL FILE
TOPOGRAPHIC DIVISION

ROAD CLASSIFICATION
Secondary highway, all weather. Light-duty road, all weather.
hard surface. improved surface
Unimproved road, fair or dry
weather

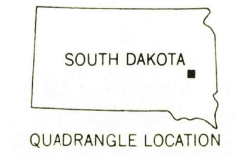

THIS MAP COMPLIES WITH NATIONAL MAP ACCURACY STANDARDS
FOR SALE BY U.S. GEOLOGICAL SURVEY, DENVER, COLORADO 80225, OR WASHINGTON, D.C. 20242
A FOLDER DESCRIBING TOPOGRAPHIC MAPS AND SYMBOLS IS AVAILABLE ON REQUEST

U.S.G.S. OLDHAM NW, S. DAK.
FILE COPY N4407.5-W9722.5/7.5
TOPOGRAPHIC DIVISION 1968
MS 6572 III NW-SERIES V873

2320
OCT 1 1970