

UNITED STATES
DEPARTMENT OF THE INTERIOR
GEOLOGICAL SURVEY

MITCHELL LAKE QUADRANGLE
SOUTH DAKOTA-HYDE CO.
7.5 MINUTE SERIES (TOPOGRAPHIC)

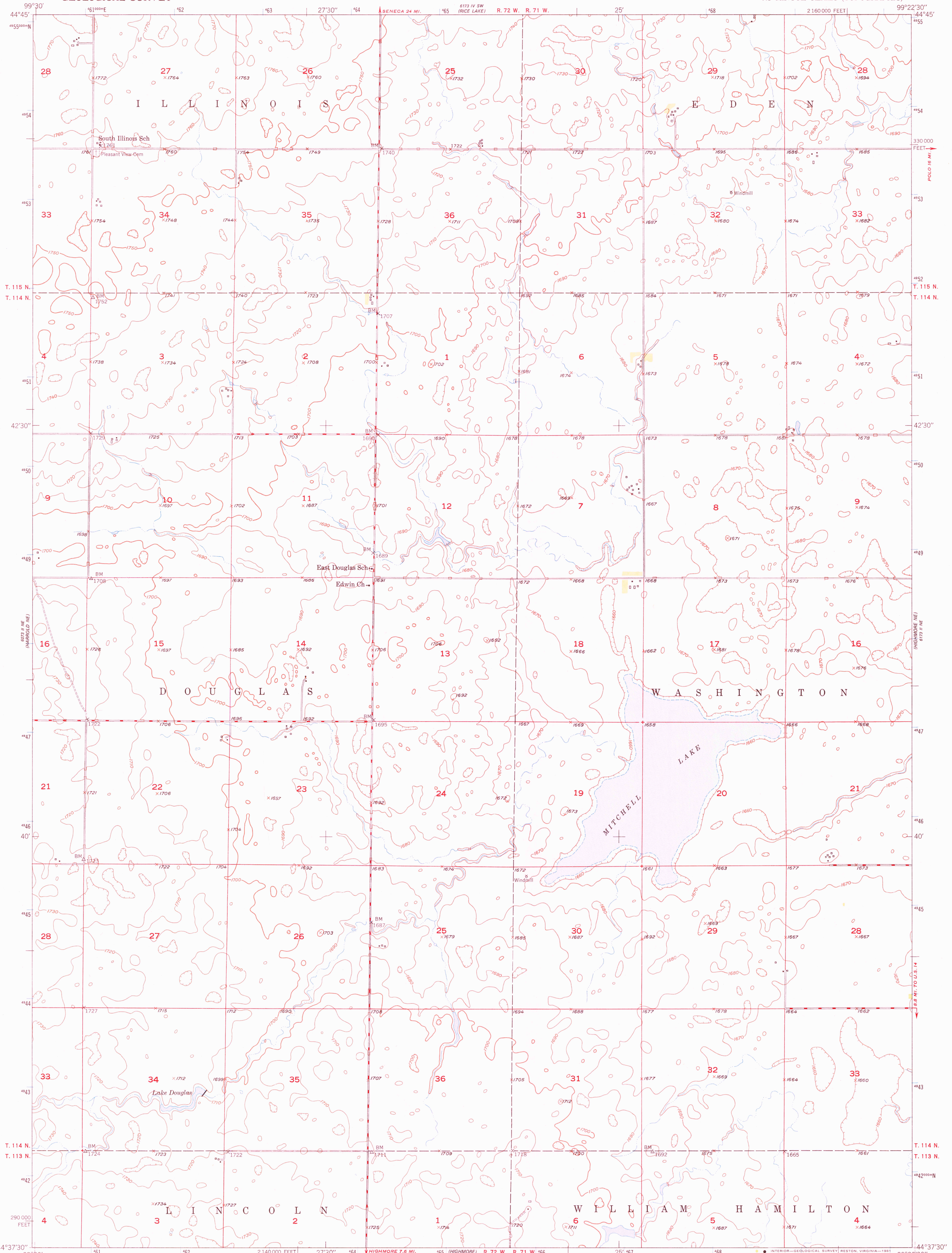

Mapped, edited, and published by the Geological Survey as part of the Department of the Interior program for the development of the Missouri River Basin Control by USGS and USC&GS

Culture and drainage in part compiled from aerial photographs taken 1948
Topography by plane-table methods 1949

Polyconic projection. 1927 North American datum
10,000-foot grid based on South Dakota coordinate system, north zone
To place on the predicted North American Datum 1983 move the projection lines 6 meters north and 32 meters east as shown by dashed corner ticks

Map photoinspected 1975
No major culture or drainage changes observed

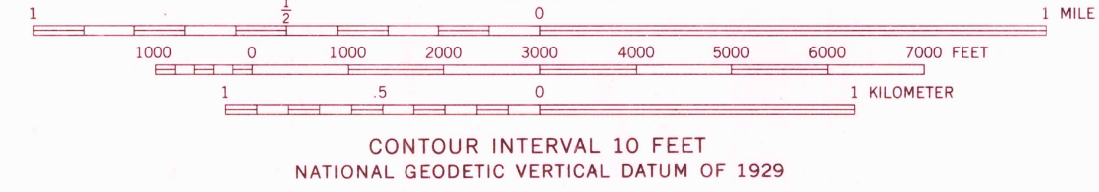
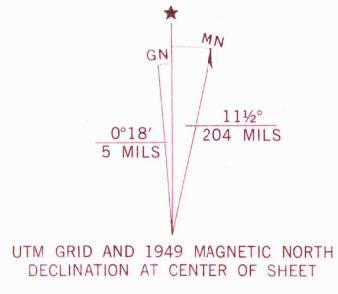

ROAD CLASSIFICATION

| | |
|---|-------------------|
| HARD-SURFACE ALL WEATHER ROADS | DRY WEATHER ROADS |
| Heavy-duty 4 LANE 16 LANE | Improved dirt |
| Medium-duty 4 LANE 16 LANE | Unimproved dirt |
| Loose-surface, graded, or narrow hard-surface | |
| U. S. Route | State Route |

MITCHELL LAKE, S. DAK.
N4437.5-W9922.517.5

1949
PHOTOINSPECTED 1975
DMA 6173 III NW-SERIES 5873

THIS MAP COMPLIES WITH NATIONAL MAP ACCURACY STANDARDS
FOR SALE BY U. S. GEOLOGICAL SURVEY, DENVER, COLORADO 80225, OR RESTON, VIRGINIA 22092
A FOLDER DESCRIBING TOPOGRAPHIC MAPS AND SYMBOLS IS AVAILABLE ON REQUEST

USGS AND HISTORICAL MAP ARCHIVES
RETURN TO:
USGS AND HISTORICAL MAP ARCHIVES

DEC 22 1981

1900