

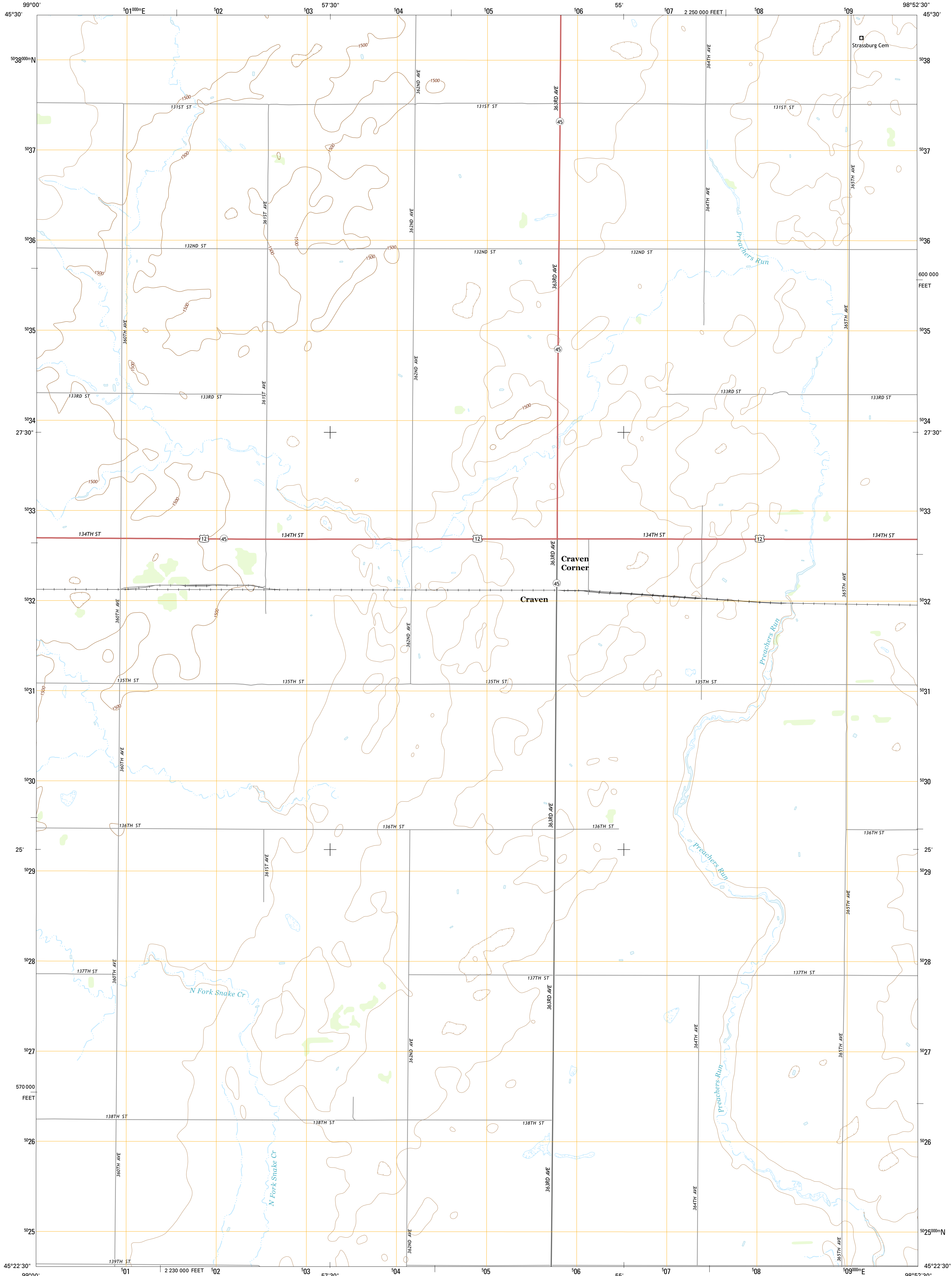

U.S. DEPARTMENT OF THE INTERIOR
U.S. GEOLOGICAL SURVEY



MINA NW QUADRANGLE
SOUTH DAKOTA-EDMUNDS CO.
7.5-MINUTE SERIES



Produced by the United States Geological Survey
North American Datum of 1983 (NAD83)
World Geodetic System of 1984 (WGS84), Projection and
1 000-meter grid: Universal Transverse Mercator, Zone 14T
10 000-foot ticks: South Dakota Coordinate System of 1983
(north zone)

This map is not a legal document. Boundaries may be
generalized for this map scale. Private lands within government
reservations may not be shown. Obtain permission before
entering private lands.

Image: N.A.P., August 2014
Roads: HERE, ©2013 - 2014
Names: G.N.I.S., 2015
Hydrography: National Hydrography Dataset, 2014
Contours: National Elevation Dataset, 2006
Boundaries: Multiple sources; see metadata file 1972 - 2015
Public Land Survey System: B.L.M., 2015

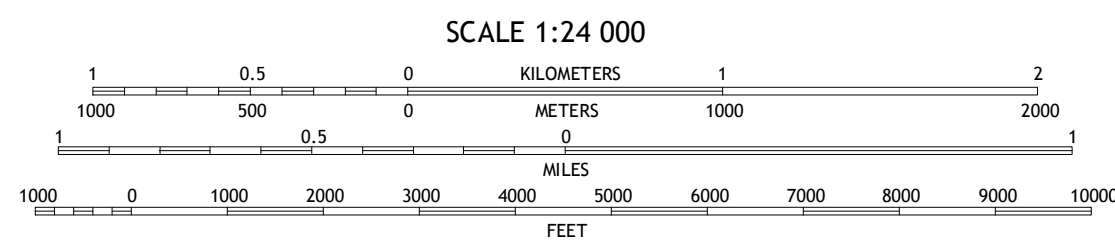
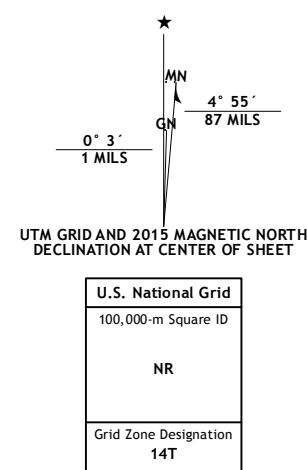

CONTOUR INTERVAL 20 FEET
NORTH AMERICAN VERTICAL DATUM OF 1988
This map was produced to conform with the
National Geospatial Program US Topo Product Standard, 2011.
A metadata file associated with this product is draft version 0.6.18

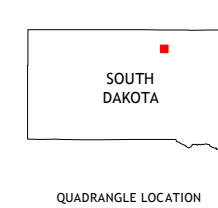

1	2	3
4	5	6
7	8	9

ADJOINING QUADRANGLES

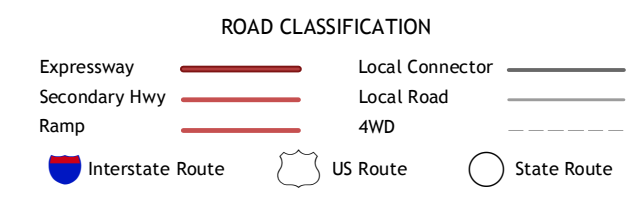

MINA NW, SD
2015

