

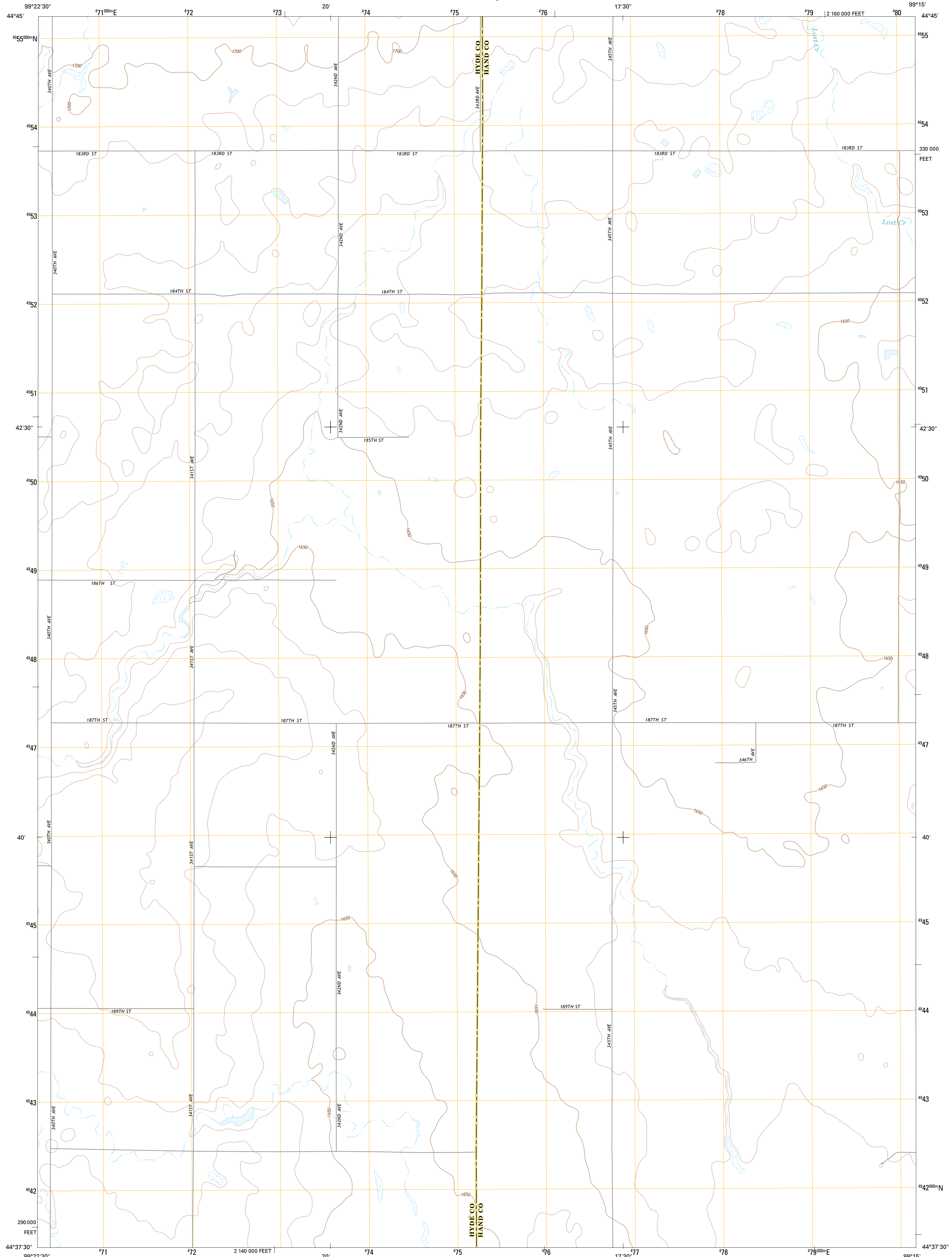

U.S. DEPARTMENT OF THE INTERIOR
U.S. GEOLOGICAL SURVEY



HIGHMORE NE QUADRANGLE
SOUTH DAKOTA
7.5-MINUTE SERIES



Produced by the United States Geological Survey
North American Datum of 1983 (NAD83)
World Geodetic System of 1984 (WGS84). Projection and
1 000-meter grid: Universal Transverse Mercator, Zone 14T
10 000-foot ticks: South Dakota Coordinate System of 1983
(north zone)

This map is not a legal document. Boundaries may be
generalized for this map scale. Private lands within government
reservations may not be shown. Obtain permission before
entering private lands.

Imagery: NAIIP, September 2014
Roads: HERE, 6/2013 - 2014
Names: GNIS, 2015
Hydrography: National Hydrography Dataset, 2014
Contours: National Elevation Dataset, 2008
Boundaries: Multiple sources; see metadata file 1972 - 2015
Public Land Survey System: BLM, 2015

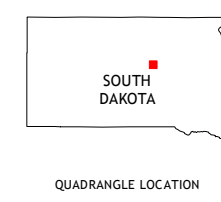
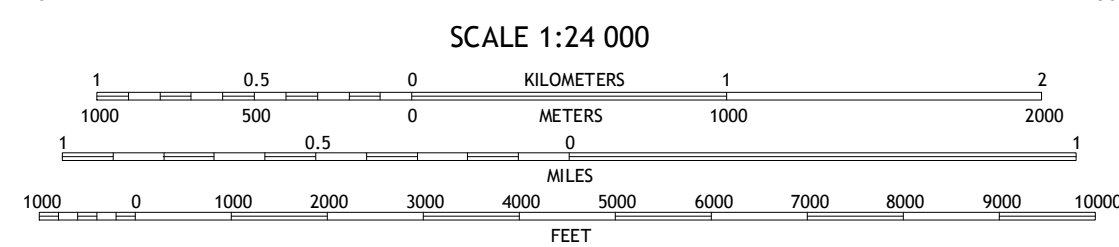
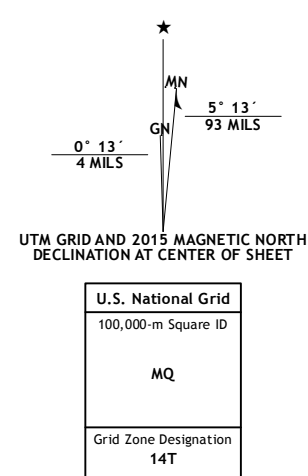

QUADRANGLE LOCATION

CONTOUR INTERVAL 10 FEET
NORTH AMERICAN VERTICAL DATUM OF 1988

This map was produced to conform with the
National Geospatial Program US Topo Product Standard, 2011.
A metadata file associated with this product is draft version 0.6.18

1	2	3	1 Rice Lake
4	5	6	2 Rezac Lake
7	8	7	3 Orient SW
		8	4 Mitchell Lake
			5 Ree Heights NW
			6 Highmore
			7 Highmore SE
			8 Ree Heights

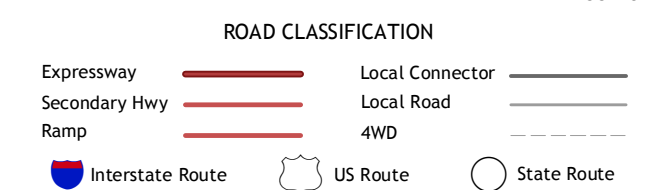

HIGHMORE NE, SD
2015

