

HIGHMORE, SOUTH DAKOTA

30 X 60 MINUTE SERIES (PLANIMETRIC)

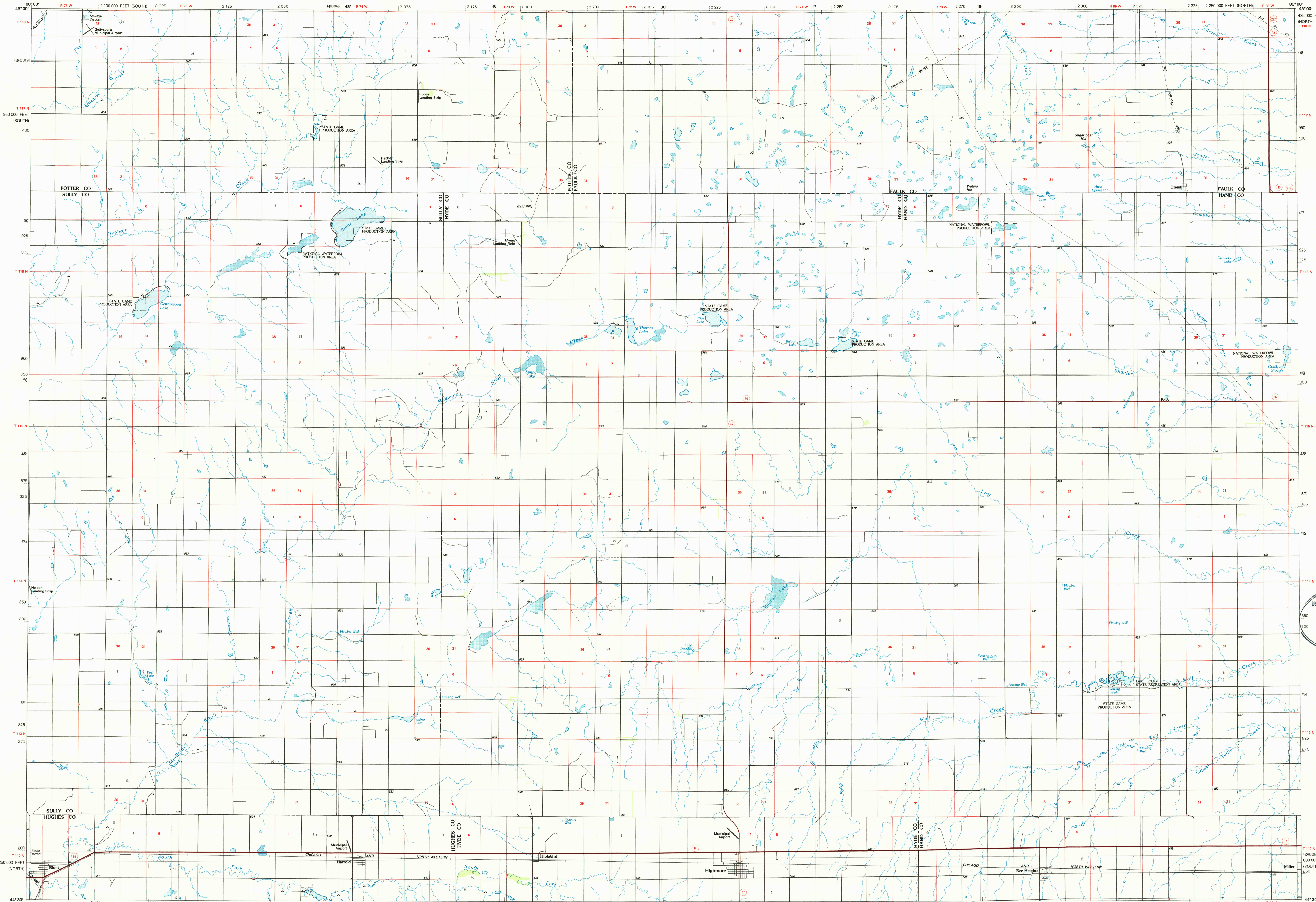

Highmore SOUTH DAKOTA

1:100 000-scale planimetric map

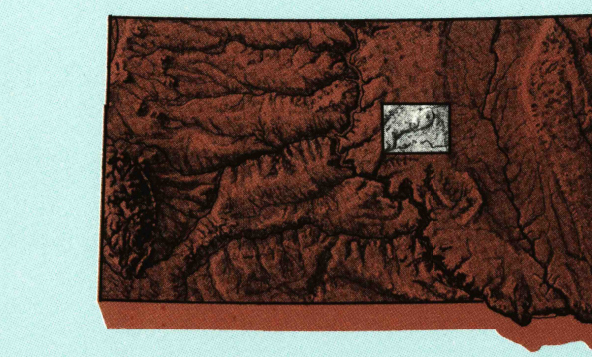

30 X 60 MINUTE QUADRANGLE SHOWING

- Elevations in meters
- Highways, roads and other manmade structures
- Water features
- Land areas
- Geographic names

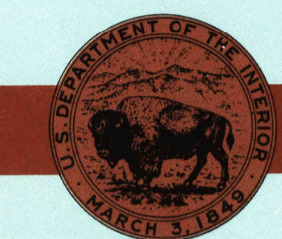

GEOLOGICAL SURVEY

1985

Produced by the United States Geological Survey. Compiled from USGS 1:24 000-scale topographic maps dated 1945-1978. Planimetry revised from aerial photographs taken 1984 and other source data. Revised information not field checked. Map edited 1985.

Projection and 10 000-meter grid, zone 14, Universal Transverse Mercator. 25 000-foot grid ticks based on South Dakota coordinate system, north and south zones. 1927 North American Datum. To place on the predicted North American Datum 1983, move the projection lines 6 meters north and 33 meters east. There may be private inholdings within the boundaries of the National or State reservations shown on this map.

NATIONAL GEODETIC VERTICAL DATUM OF 1929. ELEVATIONS SHOWN TO THE NEAREST METER.

THIS MAP COMPLIES WITH NATIONAL MAP ACCURACY STANDARDS

CONVERSION TABLE		DECLINATION DIAGRAM		ADJOINING MAPS		
Meters	Feet	Magnetic Declination		1	2	3
1	3.2808	0° 15' N		4	5	6
2	6.5617	0° 15' W		7	8	
3	9.8425	0° 15' E				
4	13.1234	0° 15' S				
5	16.4042					
6	19.6850					
7	22.9659					
8	26.2467					
9	29.5275					
10	32.8084					

To convert meters to feet multiply by 3.2808
To convert feet to meters multiply by 0.3048

UTM grid convergence (GN) and 1983 magnetic declination (MN) at center of map Diagram is approximate

1 LaPlante
2 Gettysburg
3 Aberdeen
4 Onida
5 Sisseton
6 Pierre
7 Big Bend Dam
8 Huron

FOR SALE BY U.S. GEOLOGICAL SURVEY
DENVER, COLORADO 80225, OR RESTON, VIRGINIA 22092
APR 16 1986
REC'D FILE COPY

Topographic Map Symbols

- Primary highway, hard surface
- Secondary highway, hard surface
- Light duty road, principal street, hard or improved surface
- Other road or street; trail
- Route marker: Interstate, U.S. State
- Railroad: standard gage, narrow gage
- Bridge: overpass, underpass
- Tunnel: road, railroad
- Built up area: locality, elevation
- Airport: landing field, landing strip
- National boundary
- State boundary
- County boundary
- National or State reservation boundary
- Land grant boundary
- U.S. public lands survey: range, township, section
- Range, township, section line: protracted
- Power transmission line; pipeline
- Dam; dam with lock
- Cemetery; building
- Windmill; water well; spring
- Mine shaft; adit or cave; mine, quarry; gravel pit
- Campground; picnic area; U.S. location monument
- Ruins; cliff dwelling
- Distorted surface: strip mine, lava, sand
- Contours: index, intermediate, supplementary
- Bathymetric contours: index, intermediate
- Stream, lake: perennial, intermittent
- Rapids, large and small; falls, large and small
- Area to be submerged; marsh, swamp
- Land subject to controlled inundation; woodland
- Scrub; mangrove
- Orchard; vineyard

A pamphlet describing topographic maps is available on request

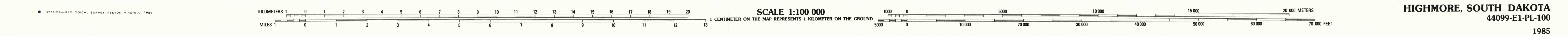

HIGHMORE, SOUTH DAKOTA 44099-E1-PL-100

1985