

U.S.G.S.
FILE COPY
Inspection and Editing.

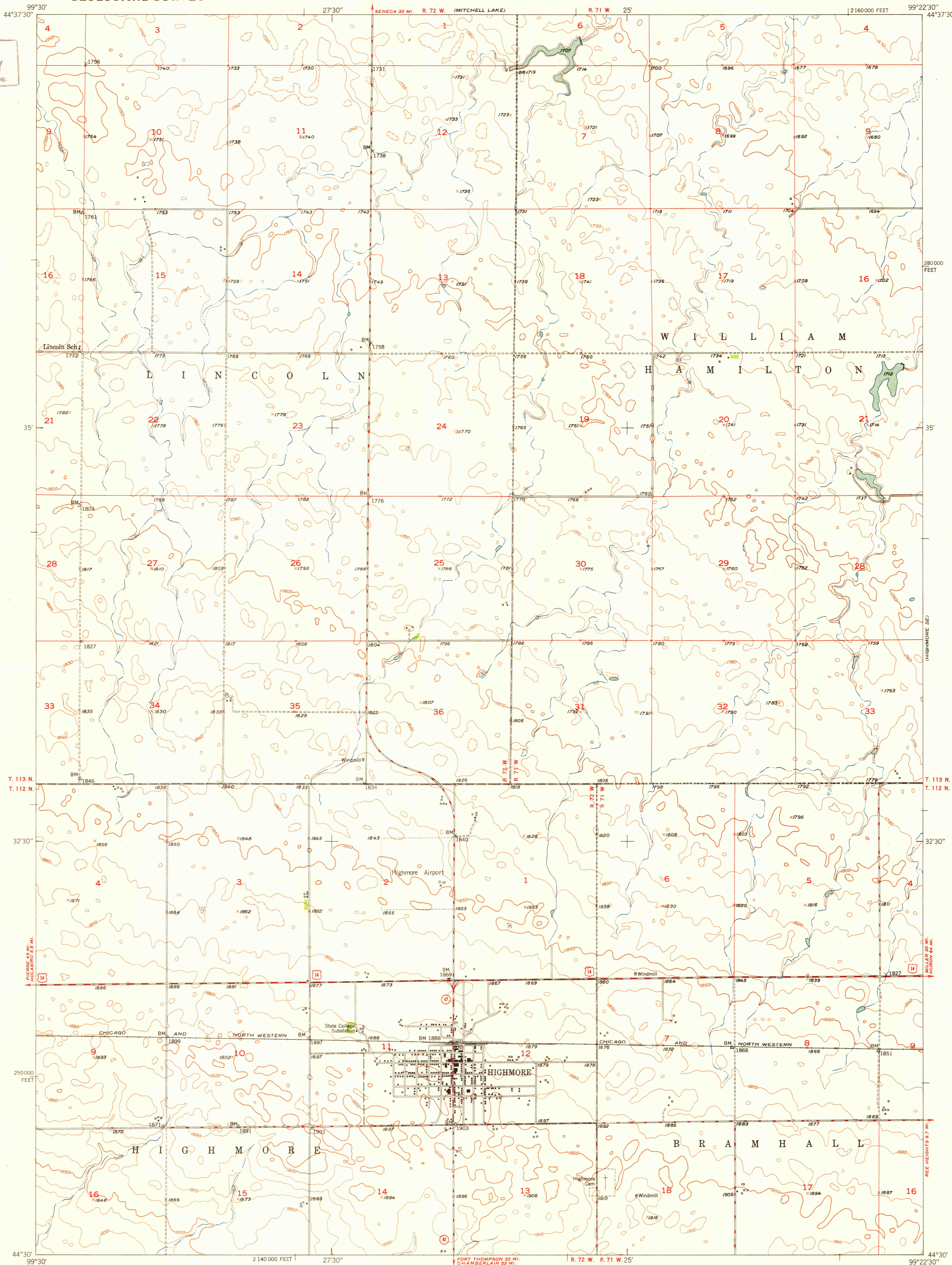

Mapped, edited, and published by the Geological Survey as part of the Department of the Interior program for the development of the Missouri River Basin. Control by USGS and USC&GS. Culture and drainage in part compiled from aerial photographs taken 1948. Topography by plane-table methods 1949. Polyconic projection. 1927 North American datum. 10,000-foot grid based on South Dakota coordinate system, north zone.

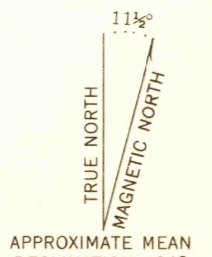

USGS
HISTORICAL FILE
TOPOGRAPHIC DIVISION

ROAD CLASSIFICATION

Heavy-duty	LANE IS LANE	Improved dirt	DRY WEATHER ROADS
Medium-duty	LANE IS LANE	Unimproved dirt	
Loose-surface, graded, or narrow hard-surface			
U. S. Route			
			State Route

U.S.G.S.
FILE COPY
Inspection and Editing.

HIGHMORE, S. DAK.
N4430-W9922.5/7.5
EDITION OF 1950

MAY 26 1950 2110