

U.S.G.S.
FILE COPY
Inspection and Editing.

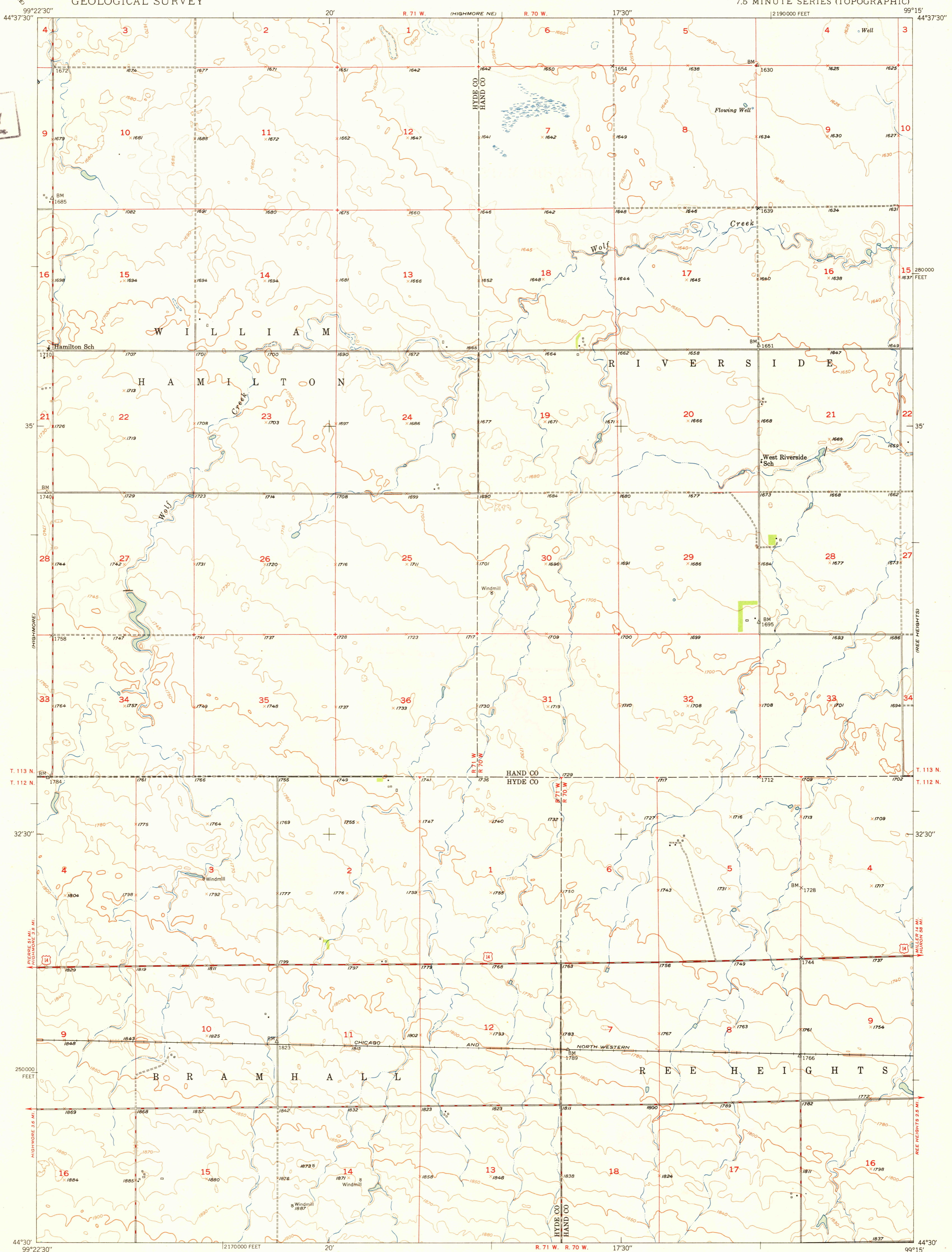

Mapped, edited, and published by the Geological Survey as part of the Department of the Interior program for the development of the Missouri River Basin. Control by USGS and USC&GS. Culture and drainage in part compiled from aerial photographs taken 1948. Topography by plane-table methods 1949. Polyconic projection. 1927 North American datum. 10,000-foot grid based on South Dakota coordinate system, north zone.

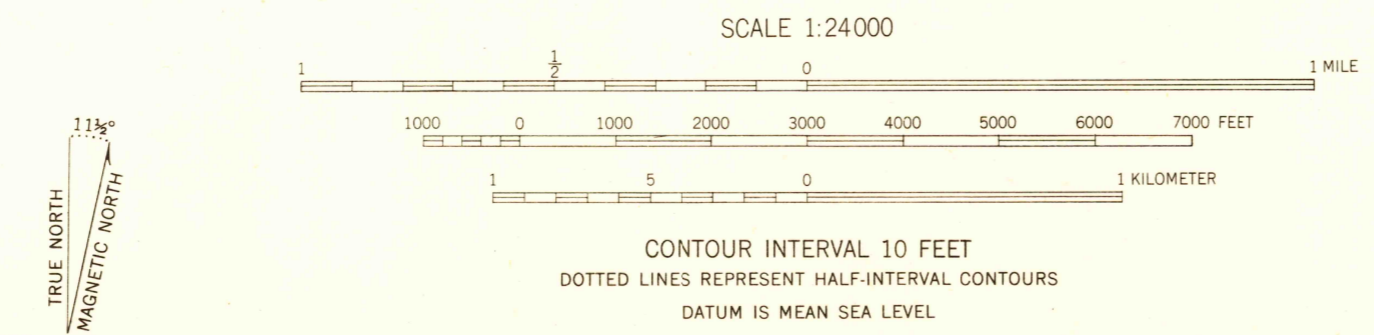

ROAD CLASSIFICATION

HARD-SURFACE ALL WEATHER ROADS	DRY WEATHER ROADS
Heavy-duty 4 LANE 18 LANE	Improved dirt
Medium-duty 4 LANE 18 LANE	Unimproved dirt
Loose-surface, graded, or narrow hard-surface	
U. S. Route	State Route

TRUE NORTH
MAGNETIC NORTH
APPROXIMATE MEAN DECLINATION, 1949

THIS MAP COMPLIES WITH NATIONAL MAP ACCURACY STANDARDS
FOR SALE BY U. S. GEOLOGICAL SURVEY, FEDERAL CENTER, DENVER, COLORADO OR WASHINGTON 25, D. C.

USGS
HISTORICAL FILE
TOPOGRAPHIC DIVISION
Inspection and Editing.

HIGHMORE SE, S. DAK.
N4430-W9915/7.5
EDITION OF 1950

MAY 26 1950 2125