

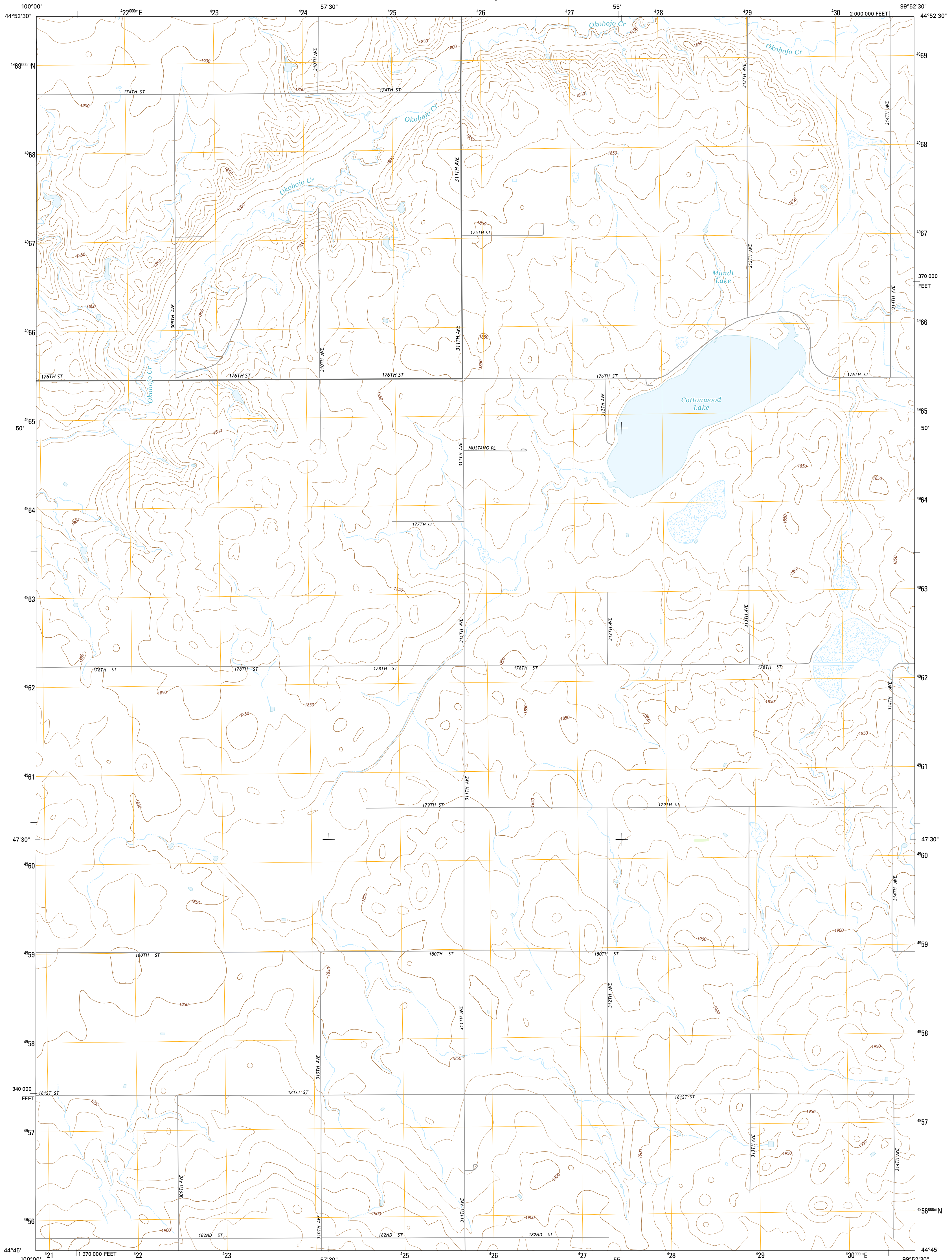

U.S. DEPARTMENT OF THE INTERIOR
U.S. GEOLOGICAL SURVEY



GETTYSBURG MUNICIPAL AIRPORT SW QUADRANGLE
SOUTH DAKOTA-SULLY CO.
7.5-MINUTE SERIES



Produced by the United States Geological Survey
North American Datum of 1983 (NAD83)
World Geodetic System of 1984 (WGS84). Projection and
1 000-meter grid: Universal Transverse Mercator, Zone 14T
10 000-foot ticks: South Dakota Coordinate System of 1983
(north zone)

This map is not a legal document. Boundaries may be
generalized for this map scale. Private lands within government
reservations may not be shown. Obtain permission before
entering private lands.

Imagery.....NAIP, September 2014
Roads.....HERE, ©2013 - 2014
Names.....GNIS, 2015
Hydrography.....National Hydrography Dataset, 2014
Contours.....National Elevation Dataset, 2012
Boundaries.....Multiple sources; see metadata file 1972 - 2015
Public Land Survey System.....BLM, 2015

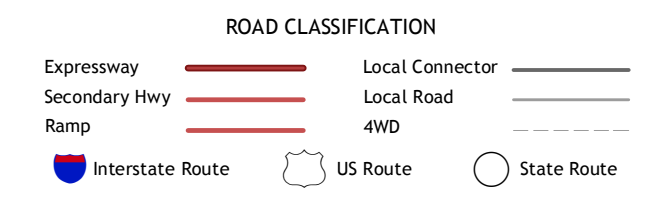
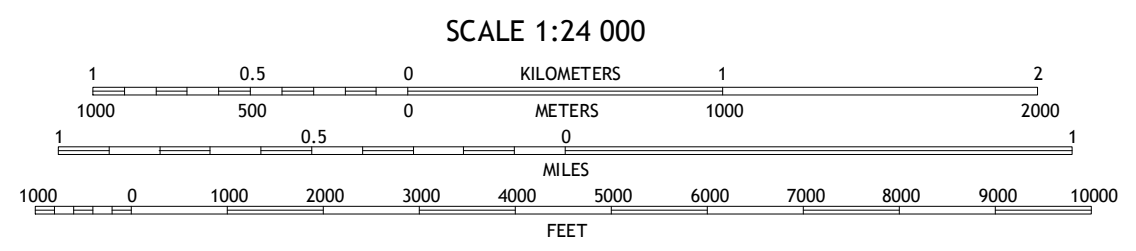
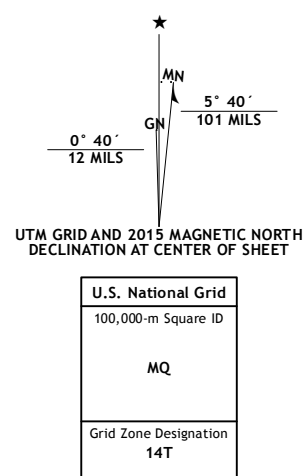

1	2	3
4	5	6
7	8	

1 Agar NE
2 Gettysburg Municipal Airport
3 Gettysburg Municipal Airport NE
4 Agar
5 Gettysburg Municipal Airport SE
6 Onida
7 Blunt NW
8 Blunt NE

GETTYSBURG MUNICIPAL AIRPORT SW, SD
2015

