

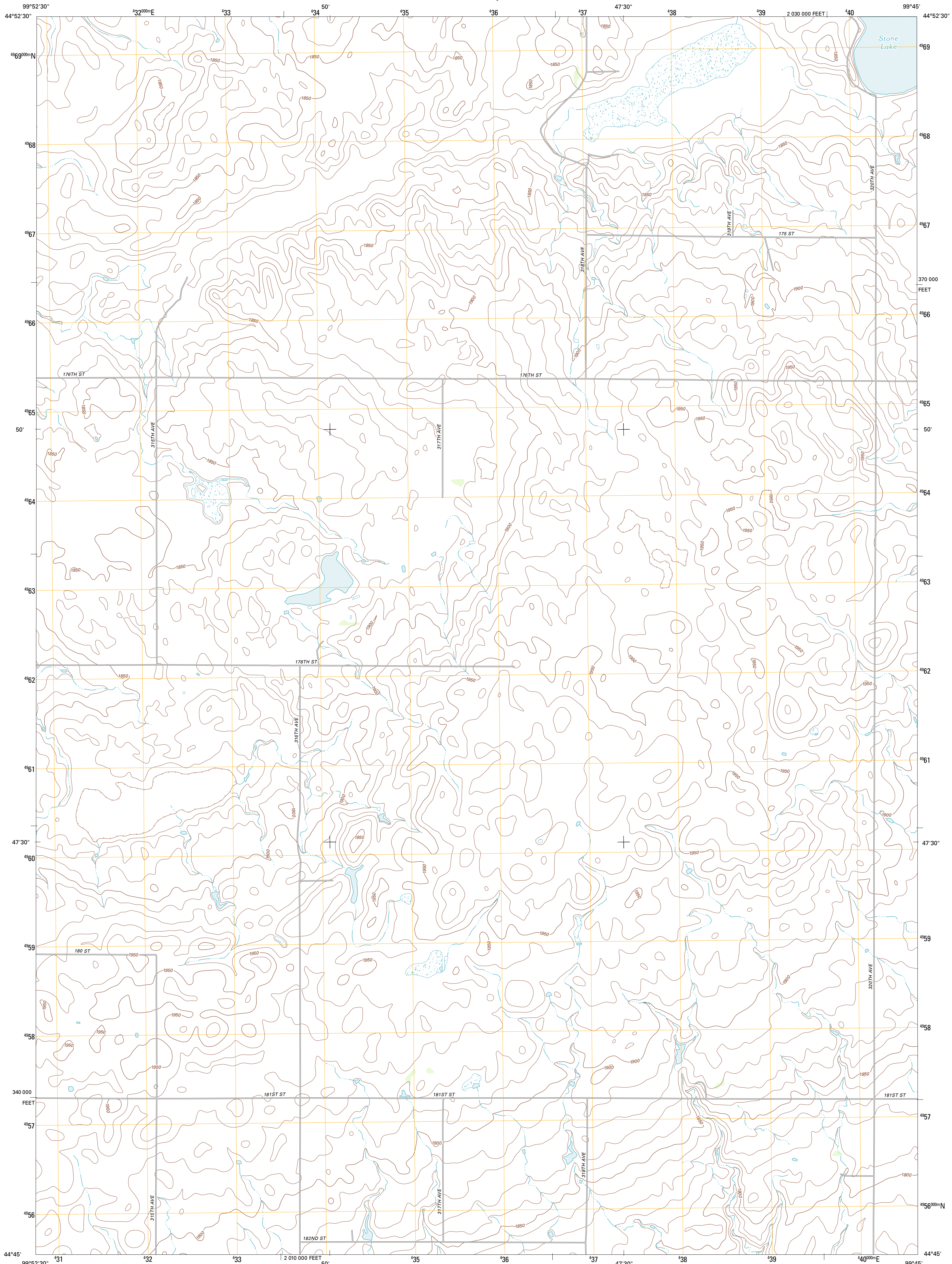

U.S. DEPARTMENT OF THE INTERIOR
U. S. GEOLOGICAL SURVEY



GETTYSBURG MUNICIPAL AIRPORT SE QUADRANGLE
SOUTH DAKOTA-SULLY CO.
7.5-MINUTE SERIES



Produced by the United States Geological Survey
North American Datum of 1983 (NAD83)
World Geodetic System of 1984 (WGS84). Projection and
1 000-meter grid: Universal Transverse Mercator, Zone 14T
10 000-foot ticks: South Dakota Coordinate System of 1983
(north zone)

Imagery.....NAIP, August 2010
Roads.....©2006-2011 TomTom
Names.....GNIS, 2011
Hydrography.....National Hydrography Dataset, 2010
Contours.....National Elevation Dataset, 2012
Boundaries.....Census, IBWC, IBC, USGS, 1972 - 2010

UTM GRID AND 2012 MAGNETIC NORTH
DECLINATION AT CENTER OF SHEET

U.S. National Grid	100 000m Square ID
MG	
Grid Zone Designation	14T

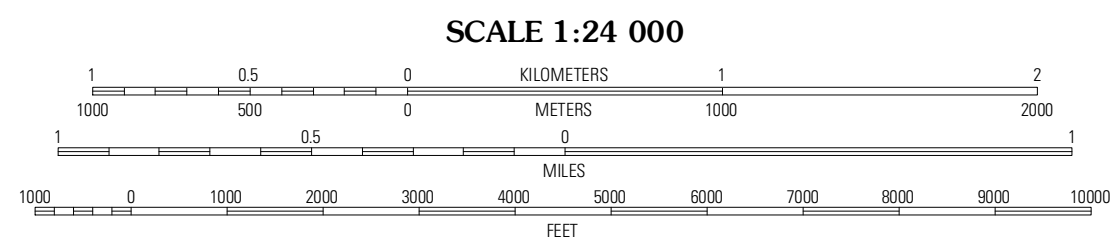

CONTOUR INTERVAL 10 FEET
NORTH AMERICAN VERTICAL DATUM OF 1988

This map was produced to conform with the
National Geospatial Program US Topo Product Standard, 2011.
A metadata file associated with this product is draft version 0.6.3

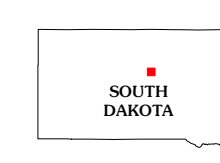

QUADRANGLE LOCATION

Gettysburg Municipal Airport	Gettysburg Municipal Airport SE	Thomas Lake NW
Gettysburg Municipal Airport SW	Gettysburg Municipal Airport SE	Thomas Lake SW
Blunt NW	Blunt NE	Harrold NW

ROAD CLASSIFICATION

Interstate Route	State Route
US Route	Local Road
Ramp	AWD
Interstate Route	US Route
	State Route

GETTYSBURG MUNICIPAL AIRPORT SE, SD
2012

ADJOINING 7.5 QUADRANGLES