

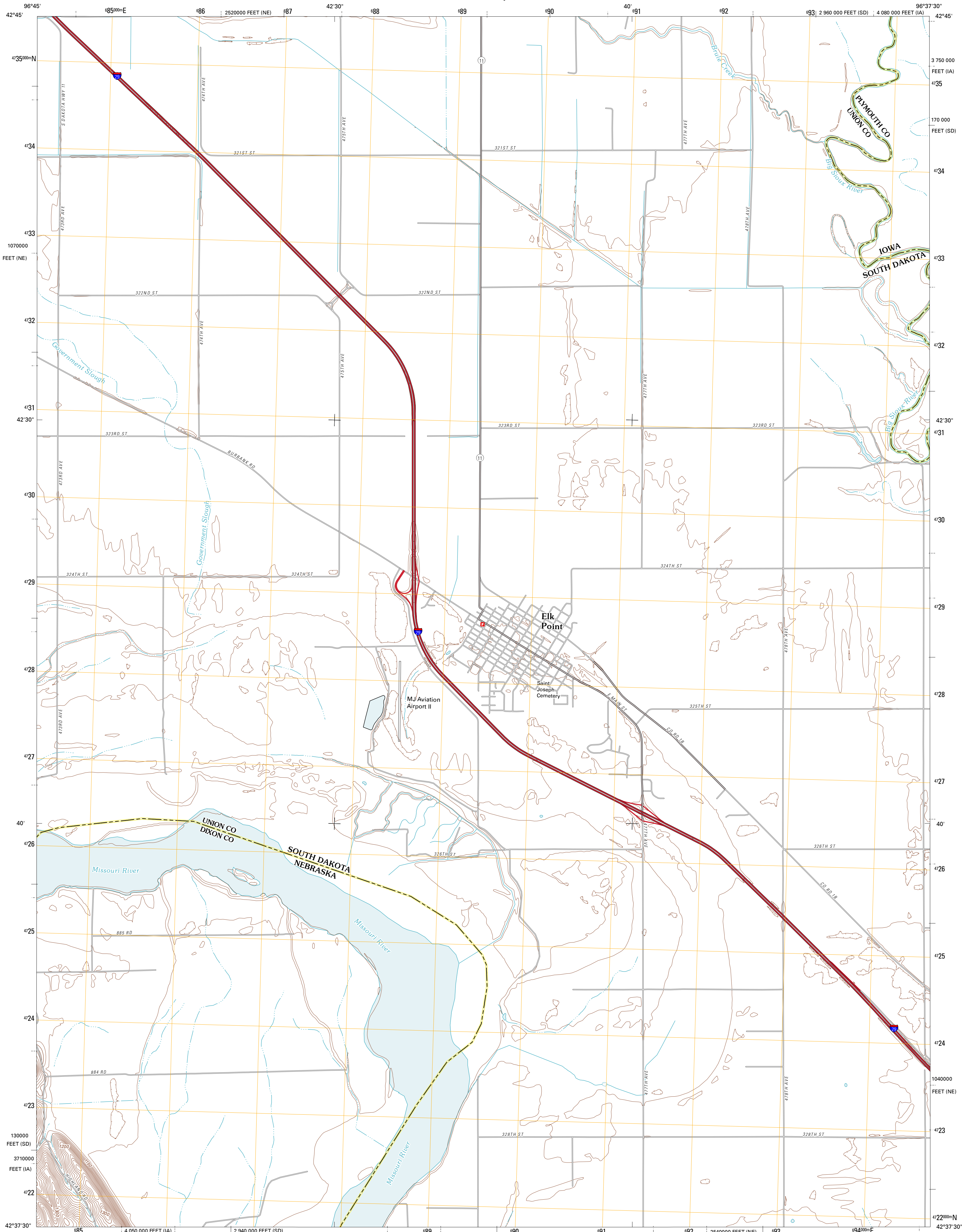

U.S. DEPARTMENT OF THE INTERIOR  
U. S. GEOLOGICAL SURVEY



ELK POINT QUADRANGLE  
SOUTH DAKOTA-NEBRASKA-IOWA  
7.5-MINUTE SERIES



Produced by the United States Geological Survey  
North American Datum of 1983 (NAD83)  
World Geodetic System of 1984 (WGS84). Projection and  
1 000-meter grid: Universal Transverse Mercator, Zone 14T  
10 000-foot ticks: South Dakota Coordinate System of 1983  
(south zone), Nebraska Coordinate System of 1983, Iowa  
Coordinate System of 1983 (north zone)

Imagery.....N.A.P., August 2010  
Roads.....©2006-2011 TomTom  
Names.....GNSS, 2011  
Hydrography.....National Hydrography Dataset, 2008  
Contours.....National Elevation Dataset, 2008  
Boundaries.....Census, IBWC, IBC, USGS, 1972 - 2010

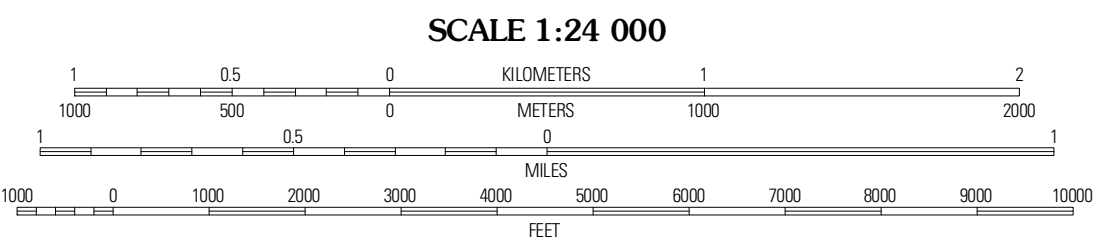
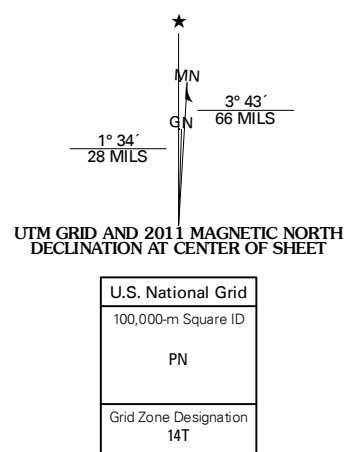

CONTOUR INTERVAL 10 FEET  
NORTH AMERICAN VERTICAL DATUM OF 1988

This map was produced to conform with the  
National Geospatial Program US Topo Product Standard, 2011.  
A metadata file associated with this product is draft version 0.6.1



Vermillion	Richland	Akron
Burbank	Elk Point	Elk Point NE
Martinsburg	Ponca	Jefferson

ADJOINING 7.5 QUADRANGLES

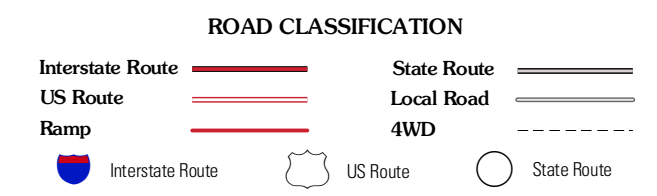

ELK POINT, SD-NE-IA  
2011