

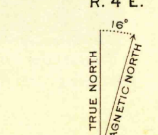

E.M. Douglas, Geographer in charge.
Triangulation by E.M. Douglas and Frank Tweedy.
Topography by W.H. Herron, A.F. Dunnington and Arthur Stiles.
Surveyed in 1897-98.
Partially revised in 1913 by R.W. Berry.

Dunnington

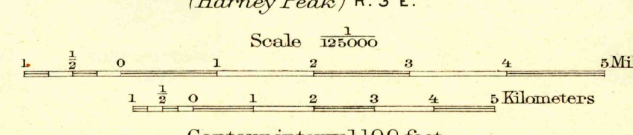

Edition of 1916 reprinted 1943
Polyconic projection.

Maps of the Spearfish and Sturgis quadrangles, scale 1:62,500, contour interval 50 feet, from a more detailed survey of the north half of this quadrangle, are available.

S.DAK. DEADWOOD TOPOGRAPHIC DIVISION

N4400-W10330/30

III 22 1042

U.S.G.S.
FILE COPY
Inspection and Editing.

USGS
HISTORICAL FILE
TOPOGRAPHIC DIVISION

4295