

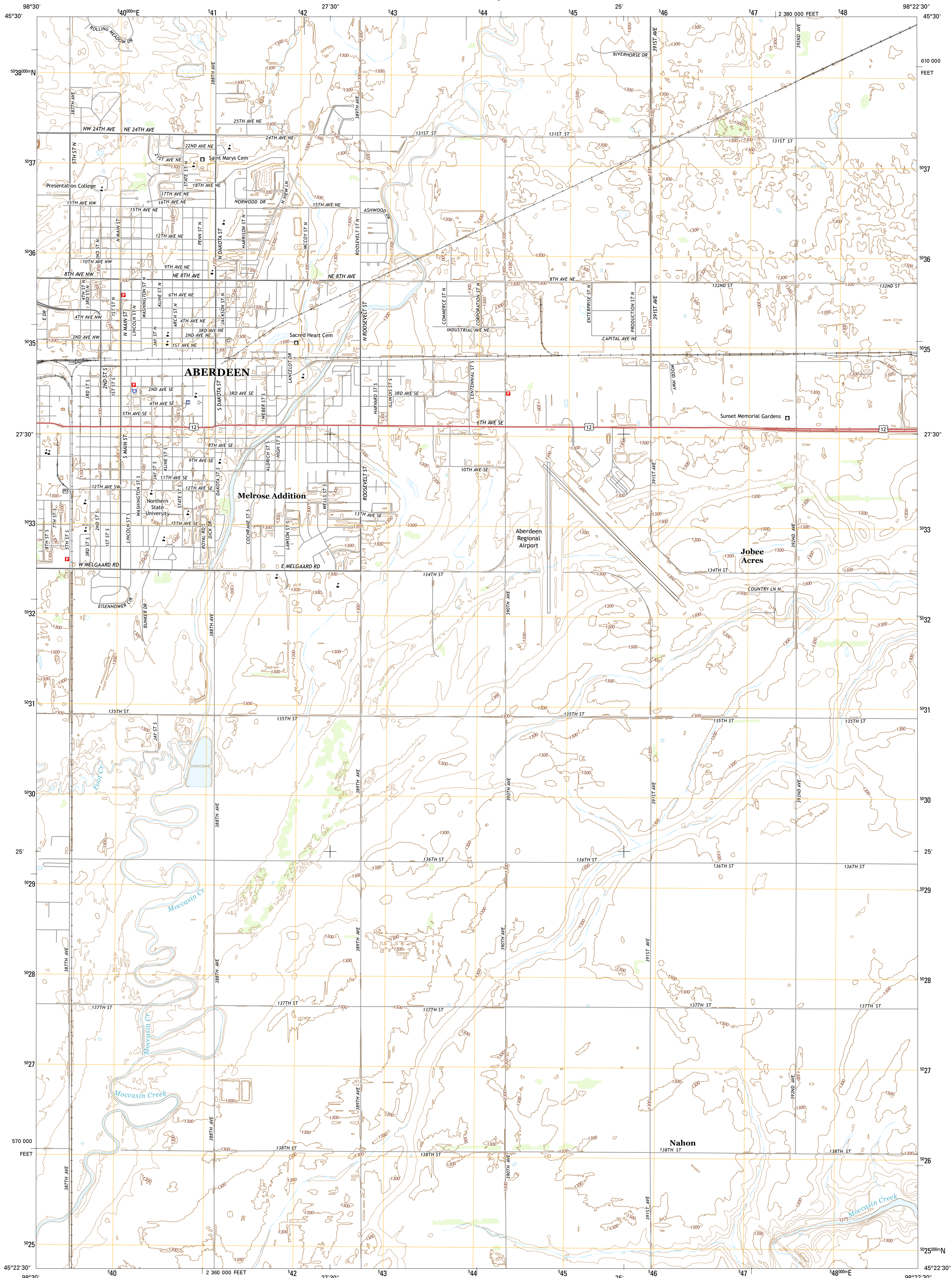

U.S. DEPARTMENT OF THE INTERIOR  
U.S. GEOLOGICAL SURVEY



ABERDEEN EAST QUADRANGLE  
SOUTH DAKOTA-BROWN CO.  
7.5-MINUTE SERIES



Produced by the United States Geological Survey  
North American Datum of 1983 (NAD83)  
World Geodetic System of 1984 (WGS84). Projection and  
1 000-meter grid: Universal Transverse Mercator, Zone 14T  
10 000-foot ticks: South Dakota Coordinate System of 1983  
(north zone)

This map is not a legal document. Boundaries may be  
generalized for this map scale. Private lands within government  
reservations may not be shown. Obtain permission before  
entering private lands.

Imagery:.....NAIP, September 2014  
Roads:.....HERE, ©2013 - 2014  
Names:.....GNIS, 2015  
Hydrography:.....National Hydrography Dataset, 2014  
Contours:.....National Elevation Dataset, 2014  
Boundaries:.....Multiple sources; see metadata file 1972 - 2015  
Public Land Survey System:.....BLM, 2015

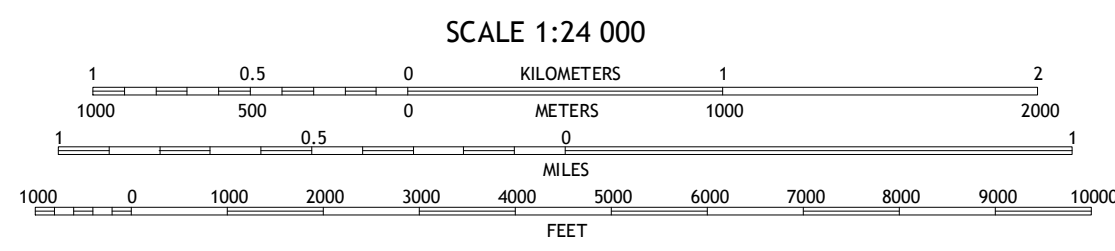
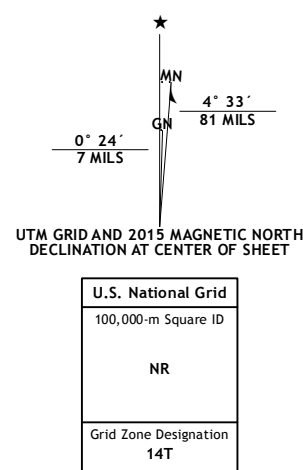

SCALE 1:24 000

CONTOUR INTERVALS FEET  
NORTH AMERICAN VERTICAL DATUM OF 1988

This map was produced to conform with the  
National Geospatial Program US Topo Product Standard, 2011.  
A metadata file associated with this product is draft version 0.6.18

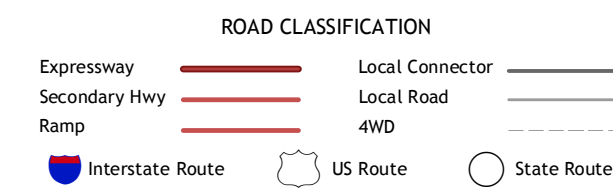
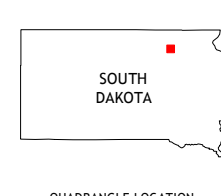

1	2	3
4	5	6
7	8	9

1 Richmond  
2 Ordway  
3 Columbia  
4 Aberdeen West  
5 Bath  
6 Rudolph  
7 Warner  
8 Stratford

ABERDEEN EAST, SD  
2015

