

UNITED STATES  
DEPARTMENT OF THE INTERIOR  
GEOLOGICAL SURVEY

SIoux CITY SOUTH QUADRANGLE  
IOWA-NEBRASKA-SOUTH DAKOTA  
7.5 MINUTE SERIES (TOPOGRAPHIC)

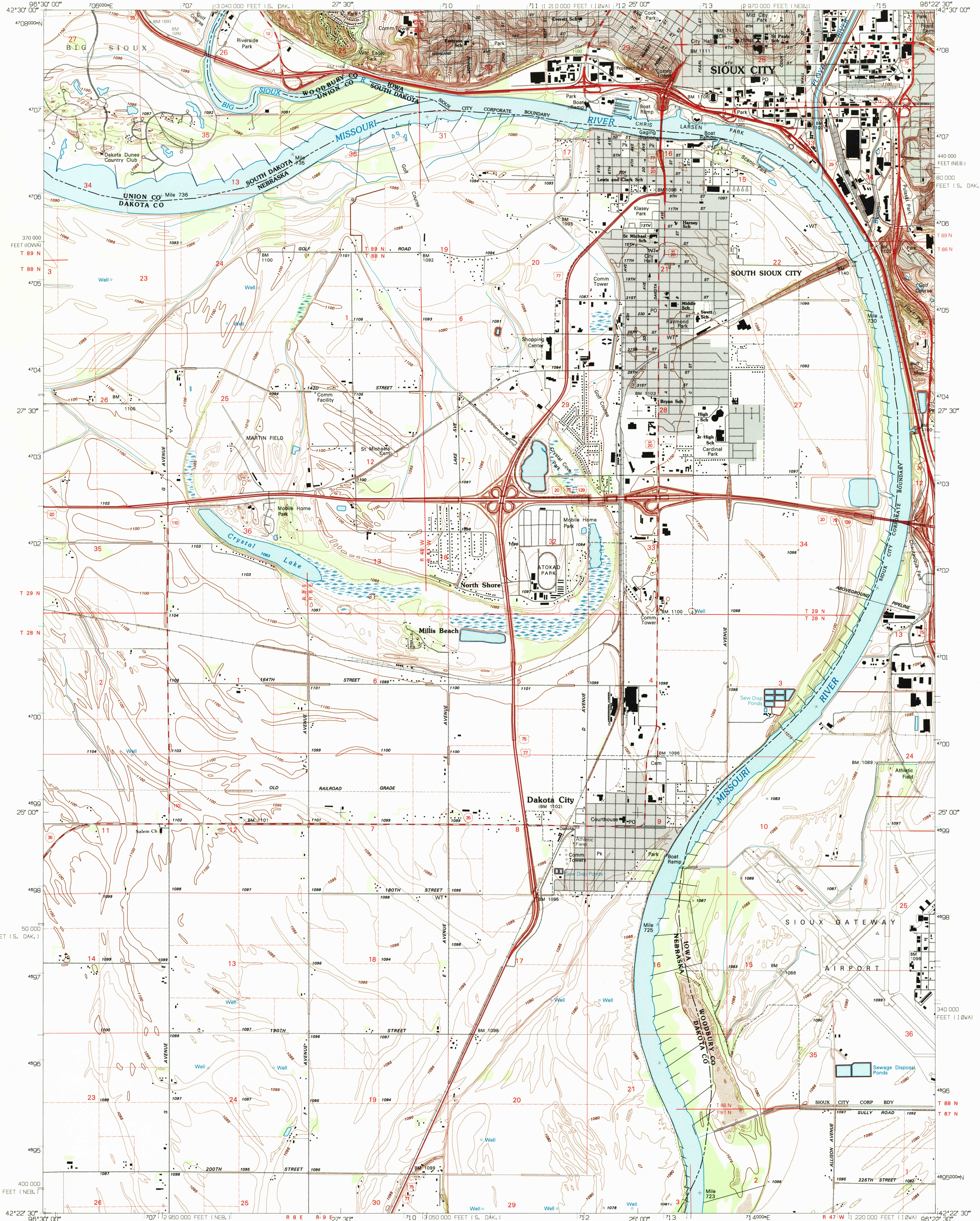

Produced by the United States Geological Survey  
Control by USGS and NOS/NOAA  
Topography by photogrammetric methods from aerial photographs taken 1961 and planimetric surveys 1963. Revised from aerial photographs taken 1991. Field checked 1995. Map edited 1995.  
Universal Transverse Mercator projection  
10,000-foot grid ticks: Nebraska coordinate system, north zone  
Iowa coordinate system, north zone, and South Dakota coordinate system, south zone  
1000-meter Universal Transverse Mercator grid ticks, zone 14, shown in blue  
1927 North American Datum (NAD 27)  
North American Datum of 1983 (NAD 83) is shown by dashed corner ticks  
The values to the shift between NAD 27 and 83 for 7.5-minute intersections are given in USGS Bulletin 1875.  
Gray tint indicates areas in which only landmark buildings are shown  
Fine red dashed lines indicate selected fence and field lines where generally visible on aerial photographs. This information is unchecked

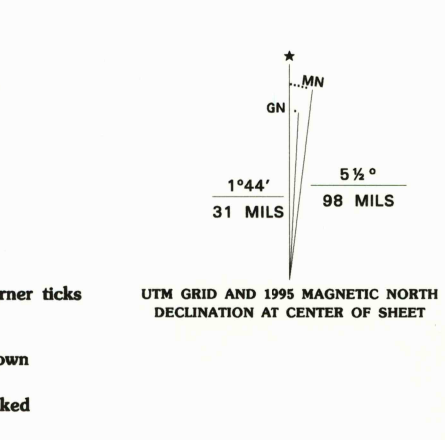

SCALE 1:24000  
CONTOUR INTERVAL 5 FEET  
NATIONAL GEODETIC VERTICAL DATUM OF 1929  
THIS MAP COMPLES WITH NATIONAL MAP ACCURACY STANDARDS  
FOR SALE BY U.S. GEOLOGICAL SURVEY, DENVER, COLORADO 80225, OR RESTON, VIRGINIA 22092  
AND IOWA GEOLOGICAL SURVEY, IOWA CITY, IOWA 52240  
A FOLDER DESCRIBING TOPOGRAPHIC MAPS AND SYMBOLS IS AVAILABLE ON REQUEST

ROAD CLASSIFICATION  
Primary highway  
Secondary highway  
hard surface  
Improved road  
Light-duty road, hard or improved surface  
Interstate Route  
U.S. Route  
State Route

QUADRANGLE LOCATION  
IOWA

1	2	3	1 Jefferson
2	3	4	2 Sioux City North
3	4	5	3 James
4	5	6	4 Jackson
5	6	7	5 Sergeant Bluff
6	7	8	6 Emerson SE
			7 Homer
			8 Salix

SIoux CITY SOUTH, IA-NE-SD  
42096-D4-TF-024  
1993  
DMA 6768 IV NW-SERIES V875

USGS 1995 HISTORICAL  
MAP ARCHIVES  
JUN 21 1995  
REC'D FILE COPY