

UNITED STATES
DEPARTMENT OF THE INTERIOR
GEOLOGICAL SURVEY

NORTH DAKOTA-MINNESOTA
GRAND FORKS QUADRANGLE

U.S.G.S
FILE COPY
Imposition and Milling

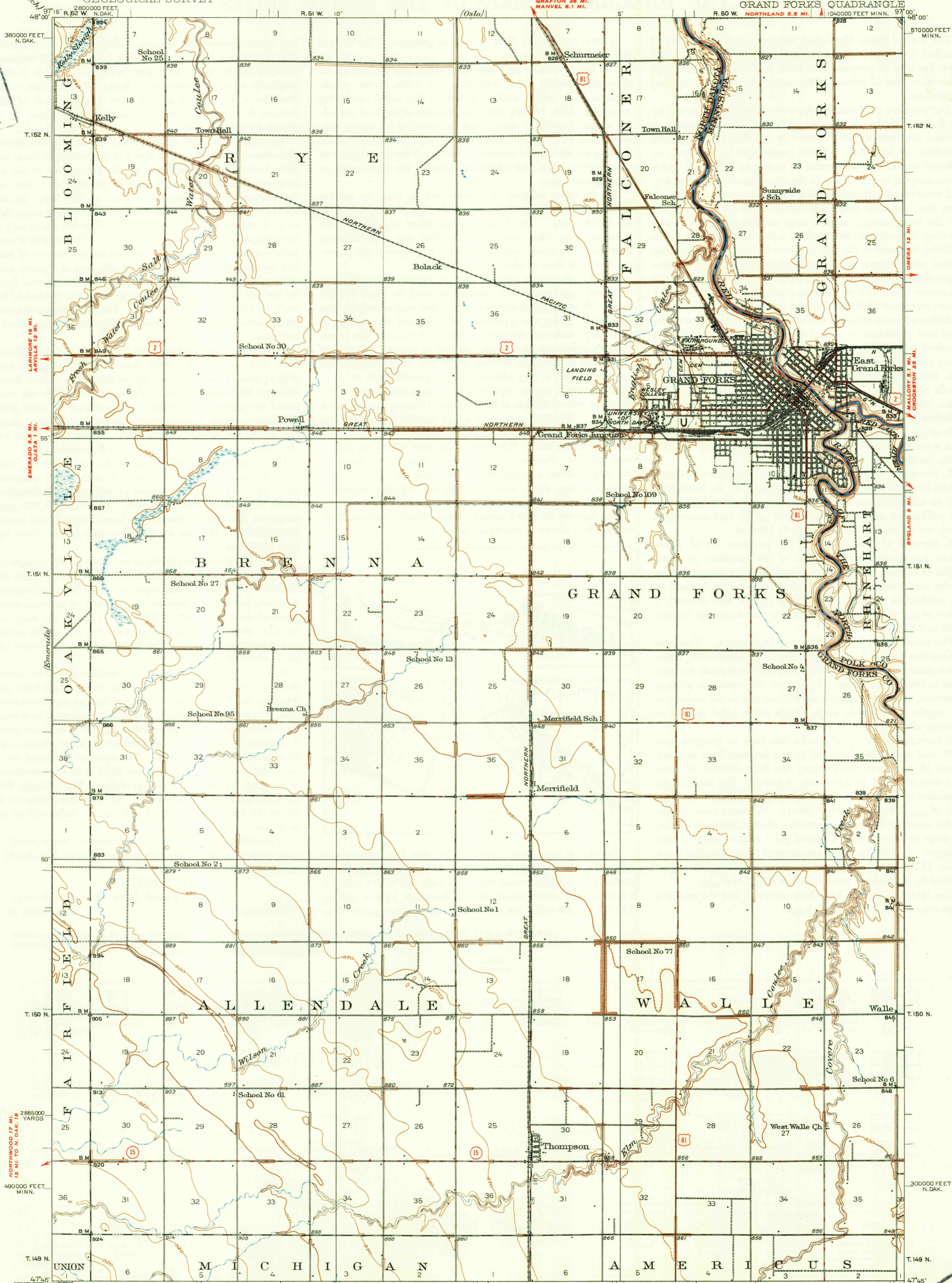

Topography by R.W. Blackburn, Daniel Kennedy,
L.V. Johnson, and Tell T. White
Surveyed in 1934

ROAD CLASSIFICATION
 HARD SURFACE ALL WEATHER ROADS DRY WEATHER ROADS
 Heavy-duty ——— 4 LANE 16 LANE Improved dirt
 Medium-duty ——— 4 LANE 16 LANE Unimproved dirt
 Loose surface, graded, or narrow hard surface ———
 U. S. Route State Route

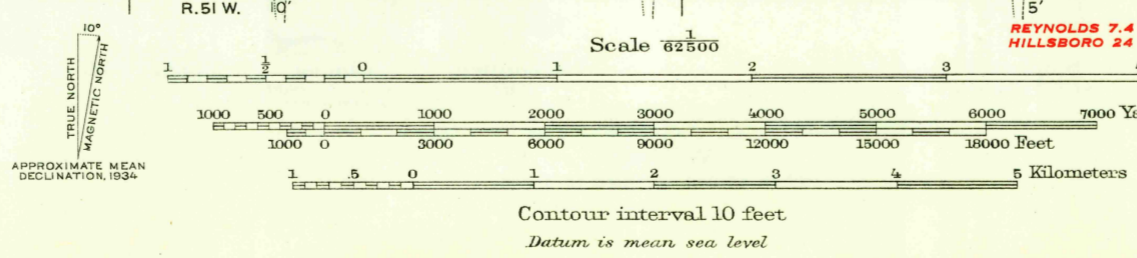

Scale 1:62,500
 Contour interval 10 feet
 Datum is mean sea level

U.S.G.S
 GRAND FORKS, N. DAK.-MINN.
 Historical File
 Topographic Division
 Edition of 1938
 reprinted 1949
 N4745-W9700/15

U.S.G.S
FILE COPY
Imposition and Milling