

files

NOT MAPPED BY U. S. G. E. PRIOR TO 1921

ADVANCE SHEET 537-N-I-E/2

MINNESOTA (BELTRAMI COUNTY) CANADA QUADRANGLE

CORPS OF ENGINEERS, U. S. ARMY PROGRESSIVE MILITARY MAP

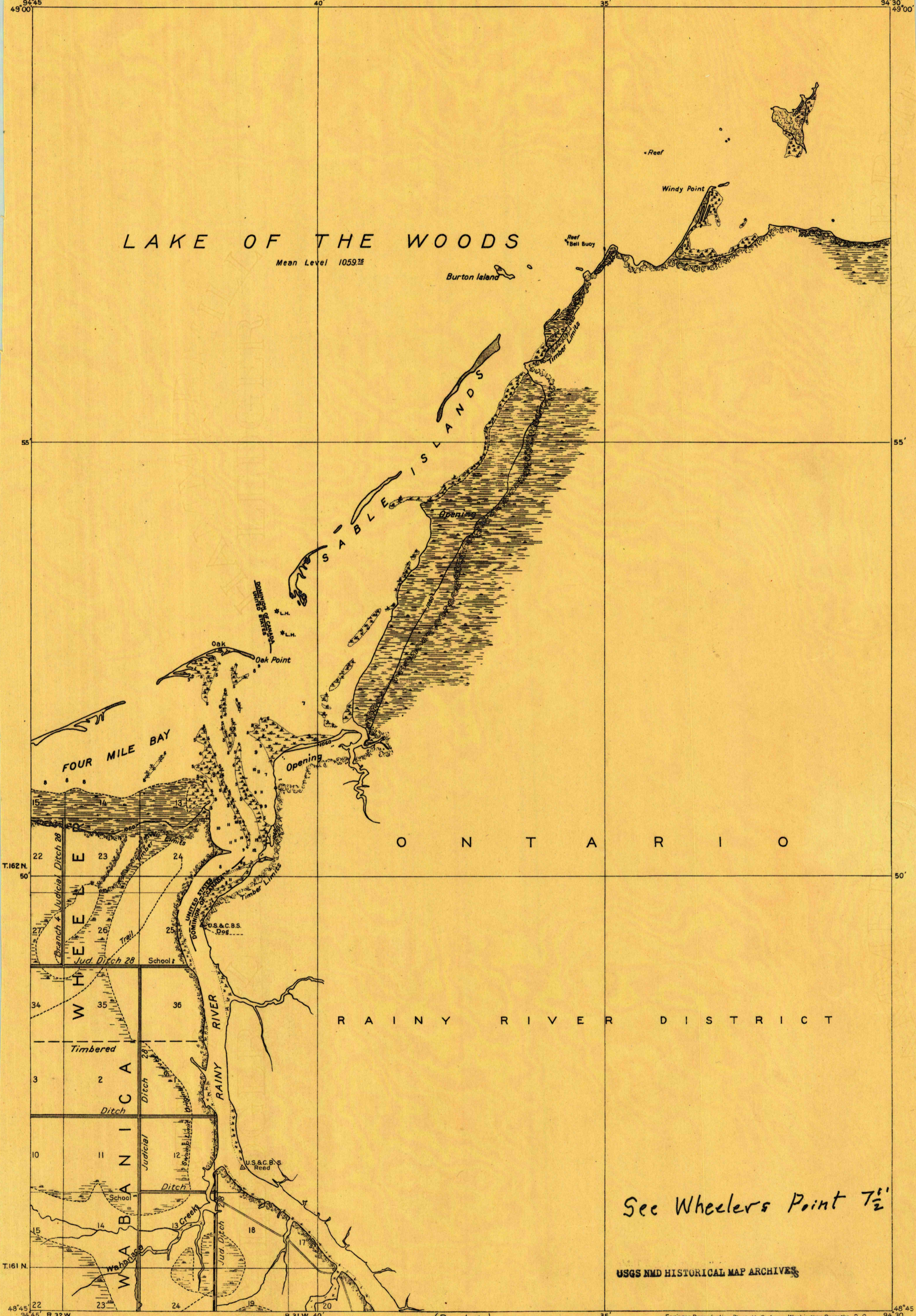

See Wheelers Point 7 1/2'

USGS NMD HISTORICAL MAP ARCHIVES

Compiled in office of Department Engineer, Central Department, 1919. From International Joint Commission sheets 1913-1914 and U. S. Canada Boundary Survey maps 1914.

RETURN TO:
USGS NMD HISTORICAL MAP ARCHIVES

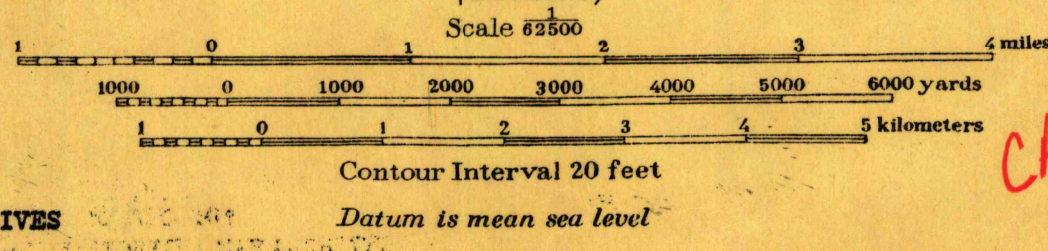

Engineer Reproduction Plant, U. S. Army, Washington Barracks, D. C. 1919

CAVADA MINN

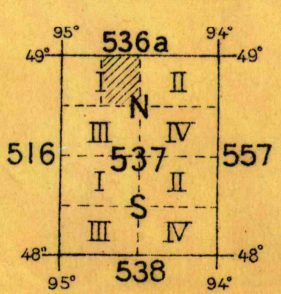

NOTE: OFFICERS USING THIS MAP WILL MARK-HEREON CORRECTIONS AND ADDITIONS WHICH COME TO THEIR ATTENTION AND MAIL DIRECT TO 'THE CHIEF OF ENGINEERS, WASHINGTON, D. C.'

TRUE NORTH
MAGNETIC NORTH
APPROXIMATE MEAN DECLINATION 1919