

(New York Mils
West 1:24,000)

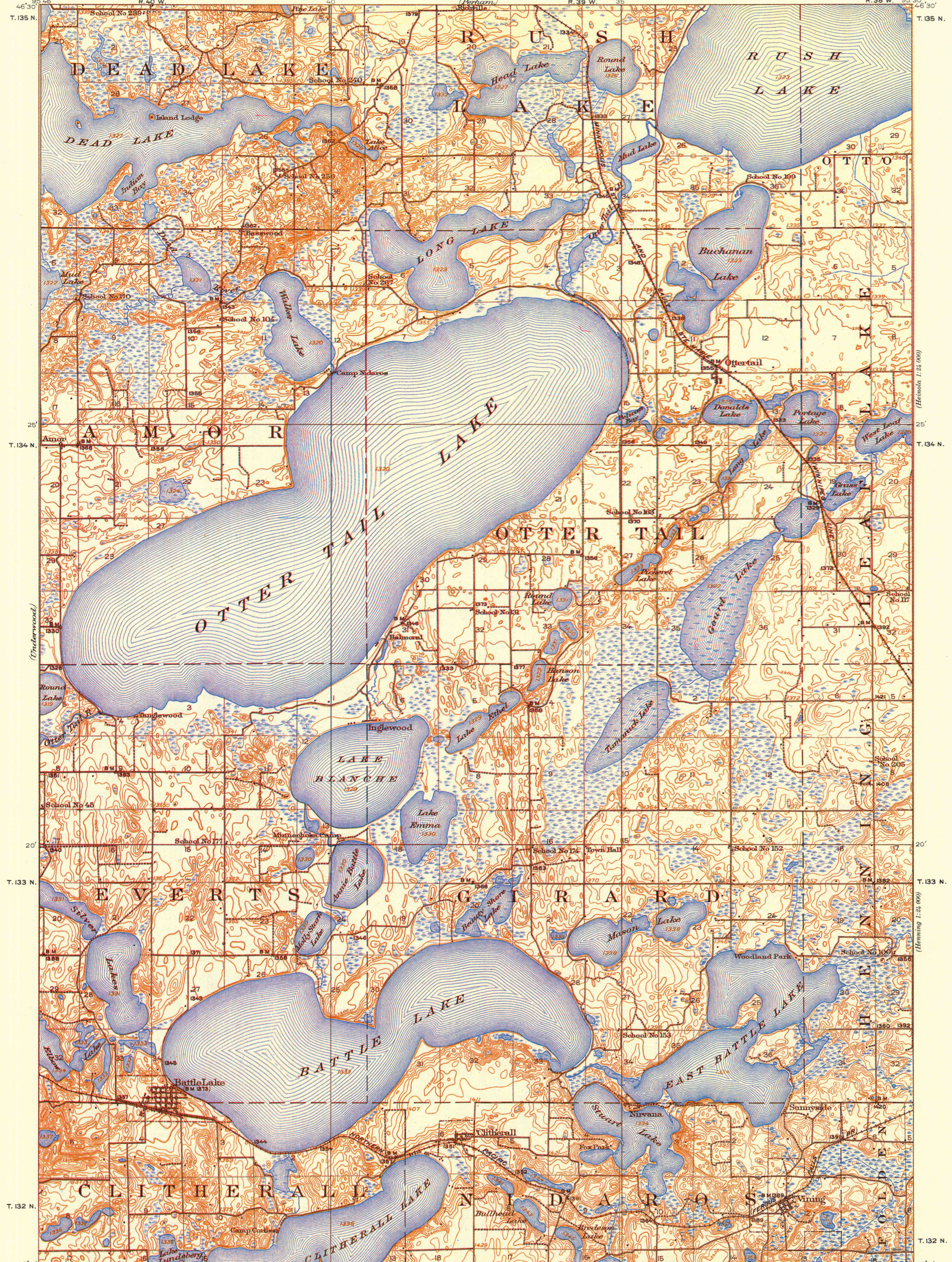

R.B. Marshall, Chief Geographer.
W.H. Herron, Geographer in charge.
Topography by C.L. Sadler,
O.H. Nelson, F.B. Barrett, and W.A. Reiter.
Control by C.B. Kendall and J.M. Ray.
Surveyed in 1911-1912.
SURVEYED IN COOPERATION WITH THE STATE OF MINNESOTA.

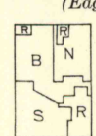

Scale $\frac{1}{82500}$
0 1 2 3 4 Miles
0 1 2 3 4 Kilometers

Contour interval 10 feet.
Datum is mean sea level.

Readjustment of levels indicates that elevations on this map are one foot too high.

FOR SALE BY U. S. GEOLOGICAL SURVEY, RESTON, VIRGINIA 22092
A FOLDER DESCRIBING TOPOGRAPHIC MAPS AND SYMBOLS IS AVAILABLE ON REQUEST

INTERIOR—GEOLOGICAL SURVEY, RESTON, VIRGINIA—1975 R. 38 W. 95 30
Edition of Aug. 1914.
Polyconic projection, North American datum.
APPROXIMATE MEAN
DECLINATION 1912

MINN.
BATTLE LAKE

N4615-W9530/15
1912

USGS

MAR 21 1975

3-5-75

1290